

# Quick Hitches

QH05, QH10, QH15, QH20, & QH30

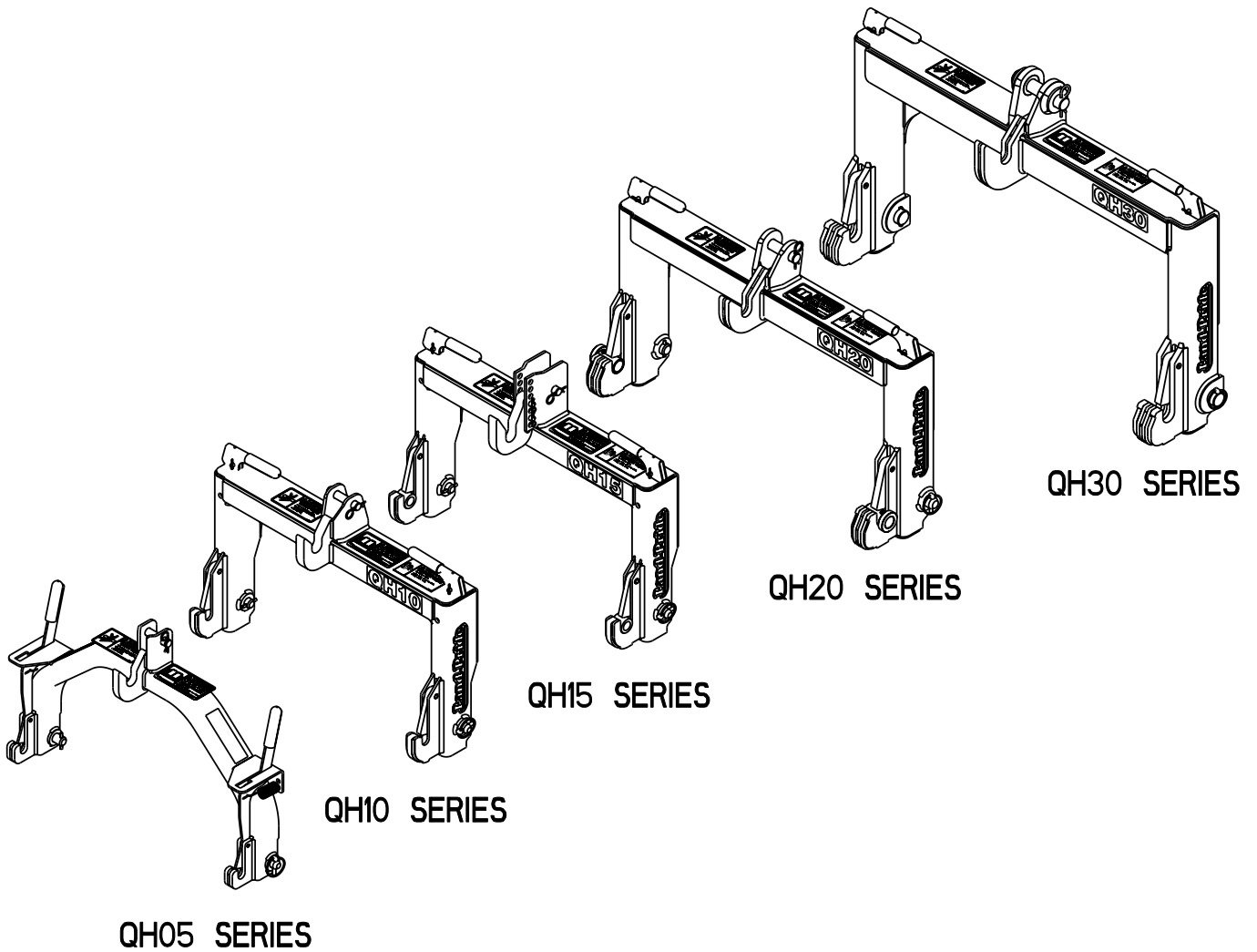

22131

## 320-003M Operator's Manual



Read the Operator's Manual entirely. When you see this symbol, the subsequent instructions and warnings are serious - follow without exception. Your life and the lives of others depend on it!

*Cover photo may show optional equipment not supplied with standard unit.*

*For an Operator's Manual and Decal Kit in French or Spanish Language, please see your Land Pride dealer.*



## Machine Identification

Record your machine details in the log below. If you replace this manual, be sure to transfer this information to the new manual.

If you, or the dealer, have added Options not originally ordered with the machine, or removed Options that were originally ordered, the weights and measurements are no longer accurate for your machine. Update the record by adding the machine weight and measurements provided in the Specifications & Capacities Section of this manual with the Option(s) weight and measurements.

<b>Model Number</b>	
<b>Serial Number</b>	
<b>Machine Height</b>	
<b>Machine Length</b>	
<b>Machine Width</b>	
<b>Machine Weight</b>	
<b>Delivery Date</b>	
<b>First Operation</b>	
<b>Accessories</b>	<hr/> <hr/> <hr/>

## Dealer Contact Information

**Name:** \_\_\_\_\_

**Street:** \_\_\_\_\_

**City/State:** \_\_\_\_\_

**Telephone:** \_\_\_\_\_

**Email:** \_\_\_\_\_

 <b>California Proposition 65</b> <b>WARNING:</b> Cancer and reproductive harm - <a href="http://www.P65Warnings.ca.gov">www.P65Warnings.ca.gov</a>
---



<b>Important Safety Information</b> . . . . .	<b>1</b>	<b>Section 2: Operating Instructions</b> . . . . .	<b>20</b>
Safety at All Times . . . . .	1	Operating Checklist . . . . .	20
Look for the Safety Alert Symbol . . . . .	1	Transporting . . . . .	20
Safety Labels . . . . .	6	Operating Instructions . . . . .	20
<b>Introduction</b> . . . . .	<b>9</b>	<b>Section 3: Optional Equipment</b> . . . . .	<b>21</b>
Application . . . . .	9	Floating Top Link . . . . .	21
Using This Manual . . . . .	9	QH05 Floating Top Link Installation . . . . .	21
Terminology . . . . .	9	QH10 Floating Top Link Installation . . . . .	22
Owner Assistance . . . . .	9	QH15 Floating Top Link Installation . . . . .	22
Serial Number . . . . .	9	QH20 Floating Top Link Installation . . . . .	23
Further Assistance . . . . .	9	Floating Top Link Positioning . . . . .	23
<b>Section 1: Assembly &amp; Set-Up</b> . . . . .	<b>10</b>	Operating Position . . . . .	23
Tractor Requirements . . . . .	10	Transporting Position . . . . .	23
Tractor Requirements Per Quick Hitch . . . . .	10	<b>Section 4: Maintenance &amp; Lubrication</b> . . . . .	<b>24</b>
QH05 Quick Hitch . . . . .	10	Maintenance . . . . .	24
QH10 Quick Hitch . . . . .	10	Long-Term Storage . . . . .	24
QH15 Quick Hitch . . . . .	10	Lubrication Points . . . . .	24
QH20 Quick Hitch . . . . .	10	Pivot points (QH10, QH15, QH20 & QH30) . . . . .	24
QH30 Quick Hitch . . . . .	10	<b>Section 5: Specifications &amp; Capacities</b> . . . . .	<b>25</b>
Tractor Hook-Up . . . . .	11	<b>Section 6: Features &amp; Benefits</b> . . . . .	<b>27</b>
Implement Hook-Up to QH05 . . . . .	12	<b>Section 7: Torque Values Chart</b> . . . . .	<b>28</b>
Hook-up Without Floating Top Links . . . . .	12	<b>Section 8: Warranty</b> . . . . .	<b>29</b>
Hook-up With Floating Top Links . . . . .	12		
Implement Hook-Up to QH10 . . . . .	13		
Hook-up Without Floating Top Links . . . . .	13		
Hook-up With Floating Top Links . . . . .	13		
Implement Hook-Up to QH15 . . . . .	14		
QH15 Upper Hook Adjustment . . . . .	14		
Lower Cat. I Single Hitch Pin Set-up . . . . .	14		
Hook-up Without Floating Top Links . . . . .	15		
Hook-up With Floating Top Links . . . . .	15		
QH15 Spare Bushings . . . . .	15		
QH20 Spare Bushings . . . . .	15		
Implement Hook-Up to QH20 . . . . .	16		
Lower Hitch Pin Set-up . . . . .	16		
Lower Clevis Pin Set-up . . . . .	16		
Hook-up Without Floating Top Links . . . . .	16		
Hook-up With Floating Top Links . . . . .	17		
Implement Hook-Up to QH30 . . . . .	17		
Unhooking Implement . . . . .	18		
Unhooking Quick Hitch . . . . .	19		



© Copyright 2022 All rights Reserved

Land Pride provides this publication “as is” without warranty of any kind, either expressed or implied. While every precaution has been taken in the preparation of this manual, Land Pride assumes no responsibility for errors or omissions. Neither is any liability assumed for damages resulting from the use of the information contained herein. Land Pride reserves the right to revise and improve its products as it sees fit. This publication describes the state of this product at the time of its publication, and may not reflect the product in the future.

Land Pride is a registered trademark.

All other brands and product names are trademarks or registered trademarks of their respective holders.

Printed in the United States of America.



## Table of Contents Continued

---

See previous page for Table of Contents.



### **Parts Manual QR Locator**

The QR (Quick Reference) code on the left will take you to the Parts Manual for this equipment. Download the appropriate App on your smart phone, open the App, point your phone on the QR code and take a picture.



### **Dealer QR Locator**

The QR code on the left will link you to available dealers for Land Pride products. Refer to Parts Manual QR Locator on this page for detailed instructions.



Listed below are common practices that may or may not be applicable to the products described in this manual.

### Safety at All Times

Careful operation is your best assurance against an accident.

All operators, no matter how much experience they may have, should carefully read this manual and other related manuals, or have the manuals read to them, before operating the power machine and this implement.

- ▲ Thoroughly read and understand the "Safety Label" section. Read all instructions noted on them.
- ▲ Do not operate the equipment while under the influence of drugs or alcohol as they impair the ability to safely and properly operate the equipment.
- ▲ The operator should be familiar with all functions of the tractor and attached implement, and be able to handle emergencies quickly.
- ▲ Make sure all guards and shields appropriate for the operation are in place and secured before operating the implement.
- ▲ Keep all bystanders away from equipment and work area.
- ▲ Start tractor from the driver's seat with hydraulic controls in neutral.
- ▲ Operate tractor and controls from the driver's seat only.
- ▲ Never dismount from a moving tractor or leave tractor unattended with engine running.
- ▲ Do not allow anyone to stand between tractor and implement while backing up to implement.
- ▲ Keep hands, feet, and clothing away from power-driven parts.
- ▲ While transporting and operating equipment, watch out for objects overhead and along side such as fences, trees, buildings, wires, etc.
- ▲ Do not turn tractor so tight as to cause hitched implement to ride up on the tractor's rear wheel.
- ▲ Store implement in a safe and secure area where children normally do not play. When needed, secure implement against falling with support blocks.



### Look for the Safety Alert Symbol

The SAFETY ALERT SYMBOL indicates there is a potential hazard to personal safety and extra precaution must be taken. When you see this symbol, be alert and carefully read the message that follows it. Hazard control, and accident prevention are dependent upon the awareness, concern, prudence, and proper training of personnel involved in the operation, transport, maintenance, and storage of equipment.

### Be Aware of Signal Words

A signal word designates a degree or level of hazard seriousness. They are:

- ▲ **DANGER:** Indicates a hazardous situation that, if not avoided, will result in death or serious injury.
- ▲ **WARNING:** Indicates a hazardous situation that, if not avoided, could result in death or serious injury.
- ▲ **CAUTION:** Indicates a hazardous situation that, if not avoided, may result in minor or moderate injury.

### Be Aware of Special Notices

Special notices are intended to point out important and helpful information that should be followed. They are usually placed inside a box. They are:

- ▲ **IMPORTANT:** Indicates that equipment or property damage could result if instructions are not followed.
- ▲ **NOTE:** Indicates supplementary explanations that will be helpful when using the equipment.

### Safety Precautions for Children

Tragedy can occur if the operator is not alert to the presence of children, Children generally are attracted to implements and their work.

- ▲ Never assume children will remain where you last saw them.
- ▲ Keep children out of the work area and under the watchful eye of a responsible adult.
- ▲ Be alert and shut the implement and tractor down if children enter the work area.
- ▲ Never carry children on the tractor or implement. There is not a safe place for them to ride. They may fall off and be run over or interfere with the control of the power machine.
- ▲ Never allow children to operate the power machine, even under adult supervision.
- ▲ Never allow children to play on the power machine or implement.
- ▲ Use extra caution when backing up. Before the tractor starts to move, look down and behind to make sure the area is clear.

### Tractor Shutdown & Storage

- ▲ If engaged, disengage power take-off.
- ▲ Park on solid, level ground and lower implement to ground or onto support blocks.
- ▲ Put tractor in park or set park brake.
- ▲ Turn off engine and remove ignition key to prevent unauthorized starting.
- ▲ Relieve all hydraulic pressure to auxiliary hydraulic lines.
- ▲ Wait for all components to stop before leaving operator's seat.
- ▲ Use steps, grab-handles and anti-slip surfaces when stepping on and off the tractor.

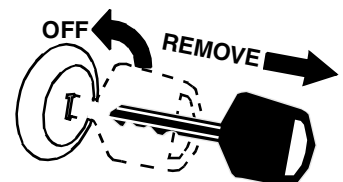

Listed below are common practices that may or may not be applicable to the products described in this manual.

### Use A Safety Chain

- ▲ A safety chain will help control drawn machinery should it separate from the tractor drawbar.
- ▲ Use a chain with the strength rating equal to or greater than the gross weight of the towed implement.
- ▲ Attach the chain to the tractor drawbar support or other specified anchor location. Allow only enough slack in the chain to permit turning.
- ▲ Always hitch the implement to the machine towing it. Do not use the safety chain to tow the implement.



### Transport Safely

- ▲ Comply with federal, state, and local laws.
- ▲ Use towing vehicle and trailer of adequate size and capacity. Secure equipment towed on a trailer with tie downs and chains.
- ▲ Sudden braking can cause a towed trailer to swerve unexpectedly. Reduce speed if towed trailer is not equipped with brakes.
- ▲ Avoid contact with any overhead utility lines or electrically charged conductors.
- ▲ Always drive with load on end of loader arms low to the ground.
- ▲ Always drive straight up and down steep inclines with heavy end of skid steer on the "uphill" side.
- ▲ Engage park brake when stopped on an incline.
- ▲ Maximum transport speed for an attached equipment is 20 mph (32 km/h). **DO NOT EXCEED.** Never travel at a speed which does not allow adequate control of steering and stopping. Some rough terrains require a slower speed.
- ▲ As a guideline, use the following maximum speed weight ratios for attached equipment:
  - 20 mph (32 km/h)** when weight of attached equipment is less than or equal to the weight of machine towing the equipment.
  - 10 mph (16 km/h)** when weight of attached equipment exceeds weight of machine towing equipment but not more than double the weight.
- ▲ **IMPORTANT:** Do not tow a load that is more than double the weight of the vehicle towing the load.

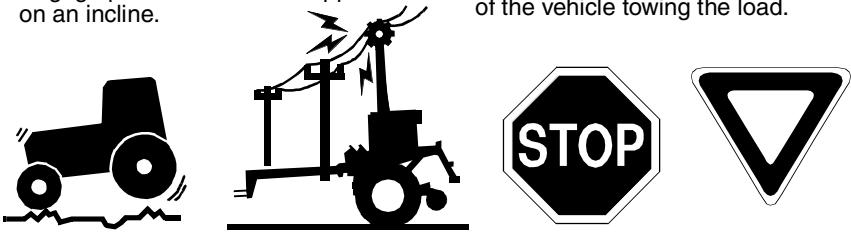

### Tire Safety

- ▲ Tire changing can be dangerous and must be performed by trained personnel using the correct tools and equipment.
- ▲ Always properly match the wheel size to the properly sized tire.
- ▲ Always maintain correct tire pressure. Do not inflate tires above recommended pressures shown in the Operator's Manual.
- ▲ When inflating tires, use a clip-on chuck and extension hose long enough to allow you to stand to one side and NOT in front of or over the tire assembly. Use a safety cage if available.
- ▲ Securely support the implement when changing a wheel.
- ▲ When removing and installing wheels, use wheel handling equipment adequate for the weight involved.
- ▲ Make sure wheel bolts have been tightened to the specified torque.



### Practice Safe Maintenance

- ▲ Understand procedure before doing work. Refer to the Operator's Manual for additional information.
- ▲ Work on a level surface in a clean dry area that is well-lit.
- ▲ Lower implement to the ground and follow all shutdown procedures before leaving the operator's seat to perform maintenance.
- ▲ Do not work under any hydraulically supported equipment. It can settle, suddenly leak down, or be lowered accidentally. If it is necessary to work under the equipment, securely support it with stands or suitable blocking beforehand.
- ▲ Use properly grounded electrical outlets and tools.
- ▲ Use correct tools and equipment for the job that are in good condition.
- ▲ Allow equipment to cool before working on it.
- ▲ Disconnect battery ground cable (-) before servicing or adjusting electrical systems or before welding on implement.
- ▲ Inspect all parts. Make certain parts are in good condition & installed properly.
- ▲ Replace parts on this implement with genuine Land Pride parts only. Do not alter this implement in a way which will adversely affect its performance.
- ▲ Do not grease or oil implement while it is in operation.
- ▲ Remove buildup of grease, oil, or debris.
- ▲ Always make sure any material and waste products from the repair and maintenance of the implement are properly collected and disposed.
- ▲ Remove all tools and unused parts from equipment before operation.
- ▲ Do not weld or torch on galvanized metal as it will release toxic fumes.



Listed below are common practices that may or may not be applicable to the products described in this manual.

**Prepare for Emergencies**

- ▲ Be prepared if a fire starts.
- ▲ Keep a first aid kit and fire extinguisher handy.
- ▲ Keep emergency numbers for doctor, ambulance, hospital, and fire department near the phone.

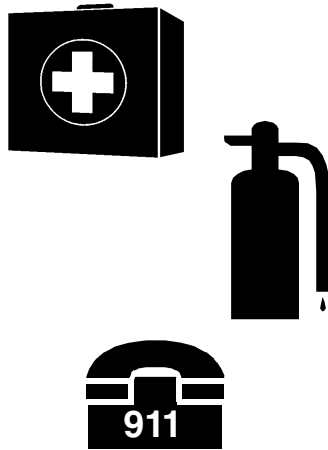

**Wear Personal Protective Equipment (PPE)**

- ▲ Wear protective clothing and equipment appropriate for the job such as safety shoes, safety glasses, hard hat, dust mask, and ear plugs.
- ▲ Clothing should fit snug without fringes and pull strings to avoid entanglement with moving parts.
- ▲ Prolonged exposure to loud noise can cause hearing impairment or hearing loss. Wear suitable hearing protection such as earmuffs or earplugs.
- ▲ Operating a machine safely requires the operator's full attention. Avoid wearing headphones while operating equipment.



**Avoid High Pressure Fluids**

- ▲ Escaping fluid under pressure will penetrate the skin or eyes causing serious injury.
- ▲ Relieve all residual pressure before disconnecting hydraulic lines or performing work on the hydraulic system.
- ▲ Make sure all hydraulic fluid connections are properly tightened/torqued and all hydraulic hoses and lines are in good condition before applying pressure to the system.
- ▲ Use a piece of paper or cardboard, NOT BODY PARTS, to check for suspected leaks.
- ▲ Wear protective gloves and safety glasses or goggles when working with hydraulic systems.
- ▲ **DO NOT DELAY.** If an accident occurs, seek immediate emergency medical care or gangrene may result.



**Use Safety Lights and Devices**

- ▲ A Slow moving power machine can create a hazard when driven on public roads. They are difficult to see, especially at night. Use the Slow Moving Vehicle (SMV) sign when on public roads.
- ▲ Flashing warning lights and turn signals are recommended whenever driving on public roads.

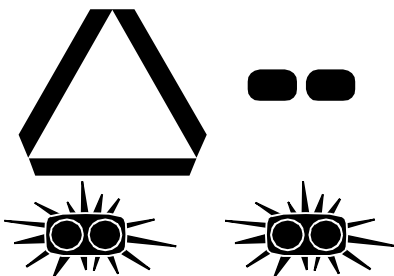

**Use Seat Belt and ROPS**

- ▲ Land Pride recommends the use of a CAB or roll-over-protective-structures (ROPS) and seat belt in almost all power machines. Combination of a CAB or ROPS and seat belt will reduce the risk of serious injury or death if the power machine should be upset.
- ▲ If ROPS is in the locked-up position, fasten seat belt snugly and securely to help protect against serious injury or death from falling and machine overturn.

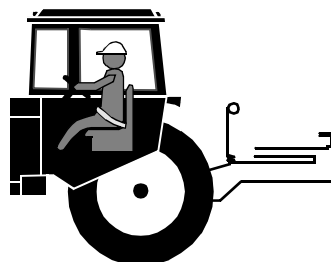

**Keep Riders Off Machinery**

- ▲ Never carry riders on the tractor or implement.
- ▲ Riders obstruct operator's view and interfere with the control of the power machine.
- ▲ Riders can be struck by objects or thrown from the equipment.
- ▲ Never use the tractor or implement to lift or transport riders.

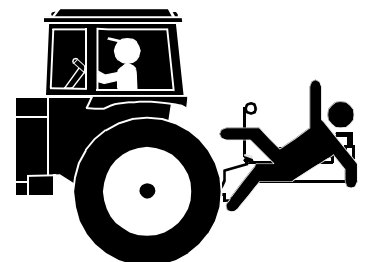

Listed below are common practices that may or may not be applicable to the products described in this manual.

### Avoid crystalline Silica (quartz) Dust

Because crystalline silica is a basic component of sand and granite, many activities at construction sites produce dust containing crystalline silica. Trenching, sawing, and boring of material containing crystalline silica can produce dust containing crystalline silica particles. This dust can cause serious injury to the lungs (silicosis).

There are guidelines which should be followed if crystalline silica (quartz) is present in the dust.



- ▲ Be aware of and follow OSHA (or other local, State, or Federal) guidelines for exposure to airborne crystalline silica.
- ▲ Know the work operations where exposure to crystalline silica may occur.
- ▲ Participate in air monitoring or training programs offered by the employer.
- ▲ Be aware of and use optional equipment controls such as water sprays, local exhaust ventilation, and enclosed cabs with positive pressure air conditioning if the machine has such equipment. Otherwise respirators shall be worn.
- ▲ Where respirators are required, wear a respirator approved for protection against crystalline silica containing dust. Do not alter respirator in any way. Workers who use tight-fitting respirators can not have beards/mustaches which interfere with the respirator seal to the face.
- ▲ If possible, change into disposable or washable work clothes at the work site; shower and change into clean clothing before leaving the work site.
- ▲ Do not eat, drink, use tobacco products, or apply cosmetics in areas where there is dust containing crystalline silica.
- ▲ Store food, drink, and personal belongings away from the work area.
- ▲ Wash hands and face before eating, drinking, smoking, or applying cosmetics after leaving the exposure area.

### Handle Chemicals Properly

- ▲ Protective clothing should be worn.
- ▲ Handle all chemicals with care.
- ▲ Follow instructions on container label.
- ▲ Agricultural chemicals can be dangerous. Improper use can seriously injure persons, animals, plants, soil, and property.
- ▲ Inhaling smoke from any type of chemical fire can be a serious health hazard.
- ▲ Store or dispose of unused chemicals as specified by the chemical manufacturer.



### Dig Safe - Avoid Underground Utilities

- ▲ **USA: Call 811**  
**CAN: [digsafecanada.ca](http://digsafecanada.ca)**  
Always contact your local utility companies (electrical, telephone, gas, water, sewer, and others) before digging so that they may mark the location of any underground services in the area.
- ▲ Be sure to ask how close you can work to the marks they positioned.





This page left blank intentionally.

## Important Safety Information

### Safety Labels

Your Quick Hitch comes equipped with all safety labels in place. They were designed to help you safely operate your implement. Read and follow their directions.

1. Keep all safety labels clean and legible.
2. Refer to this section for proper label placement. Replace all damaged or missing labels. Order new labels from your nearest Land Pride dealer. To find your nearest dealer, visit our dealer locator at [www.landpride.com](http://www.landpride.com).
3. Some new equipment installed during repair requires safety labels to be affixed to the replaced component as

specified by Land Pride. When ordering new components make sure the correct safety labels are included in the request.

4. Refer to this section for proper label placement. To install new labels:
  - a. Clean surface area where label is to be placed.
  - b. Spray soapy water onto the cleaned area.
  - c. Peel backing from label and press label firmly onto the surface.
  - d. Squeeze out air bubbles with edge of a credit card or with a similar type of straight edge.

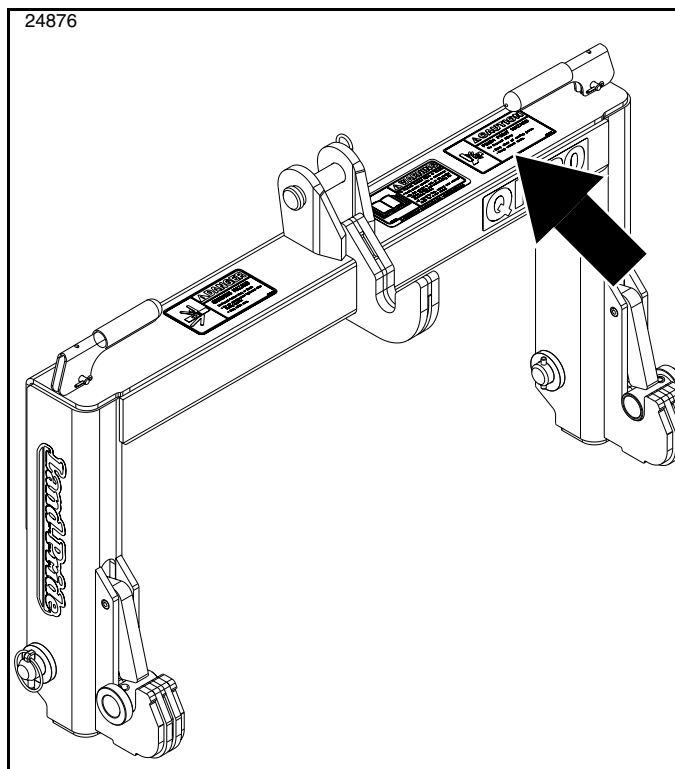

Only QH10, QH15, QH20 & QH30



**818-866C**

Caution: Pinch Point Hazard

Important Safety Information

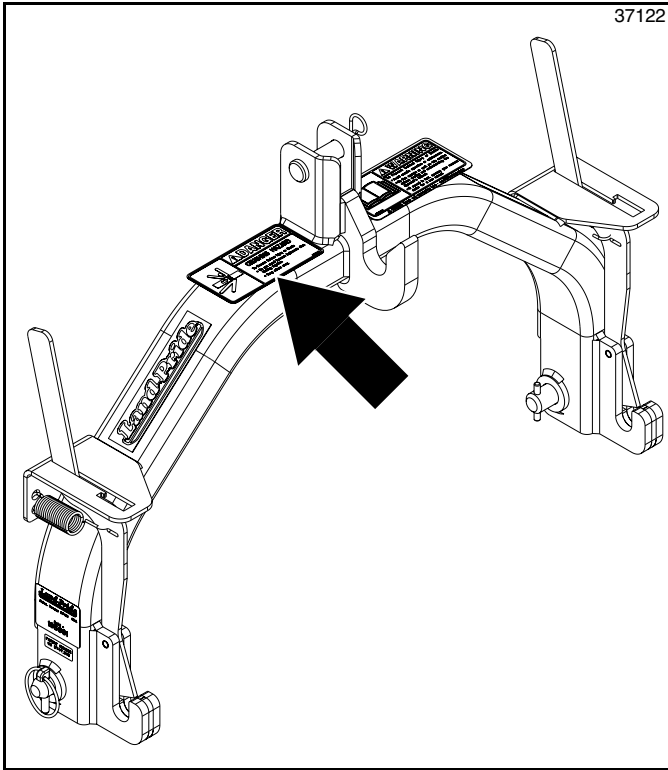

QH05

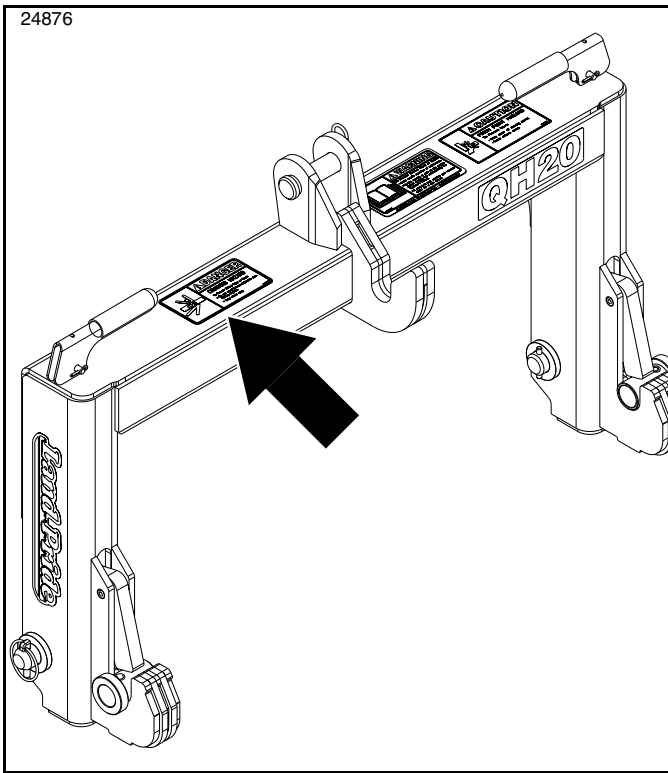

QH10, QH15, QH20 & QH30

	<b>! DANGER</b>
	<b>CRUSHING HAZARD</b> To Prevent Serious Injury or Death: <ul style="list-style-type: none"><li>• Do not stand between implements when hitching together.</li><li>• Keep others away.</li></ul>

818-714C

**818-714C**

Danger: Crushing Hazard



Important Safety Information

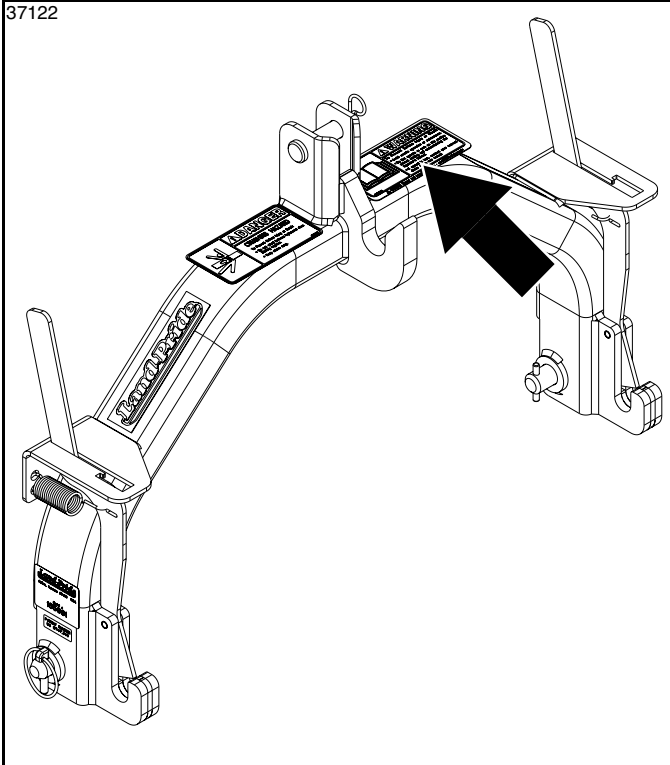

QH05

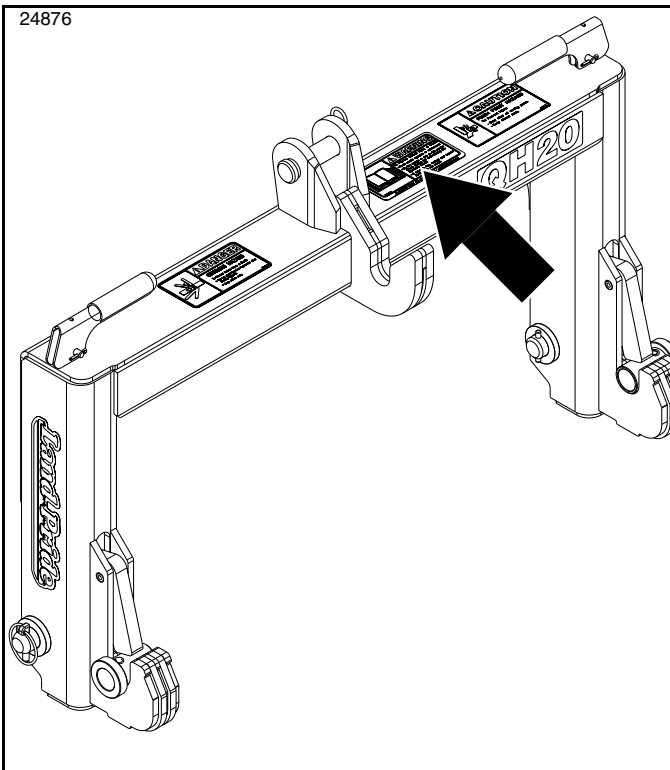

QH10, QH15, QH20 & QH30

	<b>⚠ WARNING</b>
	<p>To Prevent Serious Injury or Death:</p> <ul style="list-style-type: none"> <li>Avoid unsafe operation or maintenance.</li> <li>Do Not operate or work on this machine without reading and understanding the Operator's Manual.</li> <li>If manual is lost, contact your nearest dealer for a new manual.</li> </ul>

838-293C

⚠ WARNING: Cancer and reproductive harm - [www.P65Warnings.ca.gov](http://www.P65Warnings.ca.gov)

**838-293C**

Warning: Read Operator's Manual



## Introduction

Land Pride welcomes you to the growing family of new product owners. This Quick Hitch has been designed with care and built by skilled workers using quality materials. Proper assembly, maintenance, and safe operating practices will help you get years of satisfactory use from this Quick Hitch.

## Application

The QH05, QH10, QH15, QH20 and Qh30 Quick Hitches are designed and built by Land Pride to provide quick and easy 3-point hitch attachment and detachment of compatible implements. They are compatible with certain Land Pride mowers, rotary cutters, tillers, power rakes, rear blades, pulverizers, seeders, aerators, box scrapers, landscape rakes, and harrows.

Implement dealers, rental yards, nurseries, municipalities, implement manufacturers, landscape contractors, professional turf managers, farmers, ranchers, and large feedlot operations can increase productivity by using the Land Pride Quick Hitch.

See “**Specifications & Capacities**” on page 25 and “**Features & Benefits**” on page 27 for additional information and performance enhancing options.

## Using This Manual

- This Operator’s Manual is designed to help familiarize you with safety, assembly, operation, adjustments, troubleshooting, and maintenance. Read this manual and follow the recommendations to help ensure safe and efficient operation.
- The information contained within this manual was current at the time of printing. Some parts may change slightly to assure you of the best performance.
- To order a new Operator’s or Parts Manual, contact your authorized dealer. Manuals can also be downloaded, free-of-charge, from our website at [www.landpride.com](http://www.landpride.com)

## Terminology

“Right” or “Left” as used in this manual is determined by facing the direction the machine will operate while in use unless otherwise stated.

## Owner Assistance

The Online Warranty Registration should be completed by the dealer at the time of purchase. This information is necessary to provide you with quality customer service.

The parts on your Quick Hitch have been specially designed by Land Pride and should only be replaced with genuine Land Pride parts. Contact a Land Pride dealer if customer service or repair parts are required. Your Land Pride dealer has trained personnel, repair parts, and equipment needed to service the implement.

## Serial Number

For quick reference and prompt service, record model and serial number on the inside cover page and again on the warranty page. Always provide model number and serial number when ordering parts and in all correspondences with your Land Pride dealer. For location of your serial number plate, see Figure 1.

**NOTE:** Be sure to check both sides of the quick hitch for the serial number as it will vary

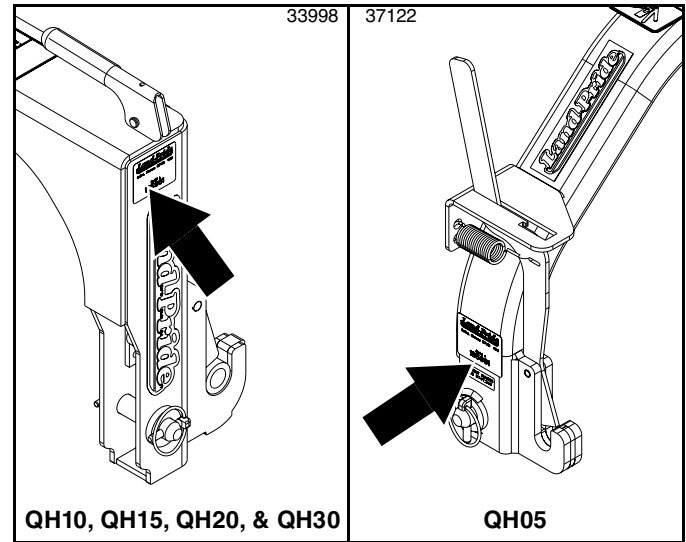

Serial Number Plate Location  
Figure 1

## Further Assistance

Your dealer wants you to be satisfied with your new Quick Hitch. If for any reason you do not understand any part of this manual or are not satisfied with the service received, the following actions are suggested:

1. Discuss any problems you have with your implement with your dealership service personnel so they can address the problem.
2. If you are still not satisfied, seek out the owner or general manager of the dealership, explain the question/problem, and request assistance.
3. For further assistance write to:

### Land Pride

#### Service Department

P.O. Box 5060  
Salina, KS 67402-5060

E-mail address

[lp servicedept@landpride.com](mailto:lp servicedept@landpride.com)



Section 1: Assembly & Set-Up

Tractor Requirements

**WARNING**

To avoid serious injury or death:

Lightweight tractors with rear attached implements may need weights added to the front to maintain steering control.

Consult your tractor Operator's Manual to determine proper weight requirements and maximum weight limitations.

**IMPORTANT:** The weight of the quick hitch must be subtracted from the maximum weight allowed for an attached implement. See maximum weight of attached implement under "Tractor Requirements Per Quick Hitch" on this page.

**IMPORTANT:** Some Cat. I & II implements and/or tractors may not meet Quick Hitch standards. Modifications are sometimes made to the implement and/or tractor to accommodate the Quick Hitch. **Any modification made to the Quick Hitch or implement could void the warranty.**

Tractor Requirements Per Quick Hitch

**QH05 Quick Hitch**

Tractor maximum horsepower . . . . . 28 hp (21 kW)  
 Hitch category . . . . . Cat. I  
 Lower 3-point hitch link holes . . . . 7/8" (22 mm) Dia.  
 Top center 3-point hitch link hole . . 3/4" (19 mm) Dia.  
 \*Maximum implement weight at 24" (61 cm) back from  
 implement's lower hitch pins . . . . 700 lbs (317 kg)  
 Refer to QR code below for compatible implements that  
 can be used with the QH05 Quick Hitch.



**QH10 Quick Hitch**

Tractor horsepower . . . . . 20-60 hp (15-45 kW)  
 3-Point hitch category . . . . . Cat. I  
 Lower 3-point hitch link holes . . . . 7/8" (22 mm) Dia.  
 Top center 3-point hitch link hole . . 3/4" (19 mm) Dia.  
 \*Maximum implement weight at 24" (61 cm) back from  
 implement's lower hitch pins . . . . 2000 lbs (907 kg)

**QH15 Quick Hitch**

Tractor horsepower . . . . . 20-60 hp (15-45 kW)  
 3-Point hitch category . . . . . Cat. I  
 Lower 3-point hitch link holes . . . . 7/8" (22 mm) Dia.  
 Top center 3-point hitch link hole . . 3/4" (19 mm) Dia.  
 \*Maximum implement weight at 24" (61 cm) back from  
 implement's lower hitch pins . . . . 2000 lbs (907 kg)

**QH20 Quick Hitch**

Tractor horsepower . . . . . 40-110 hp (30-82 kW)  
 3-Point hitch category . . . . . Cat. II  
 Lower 3-point hitch link holes . . . 1 1/8" (29 mm) Dia.  
 Top center 3-point hitch link hole . . . 1" (25 mm) Dia.  
 \*Maximum implement weight at 24" (61 cm) back from  
 implement's lower hitch pins . . . 3600 lbs (1633 kg)

**QH30 Quick Hitch**

Tractor maximum horsepower . . . . . 225 hp (168 kW)  
 3-Point hitch category . . . . . Cat. III  
 Lower 3-point hitch link holes . . 1 7/16" (36 mm) Dia.  
 Top center 3-point hitch link hole . 1 1/4" (32 mm) Dia.  
 \*Maximum implement weight at 24" (61 cm) back from  
 implement's lower hitch pins . . 13,600 lbs (6169 kg)

\* See important Note above regarding subtracting quick hitch weight from implement weight.

Section 1: Assembly & Set-Up

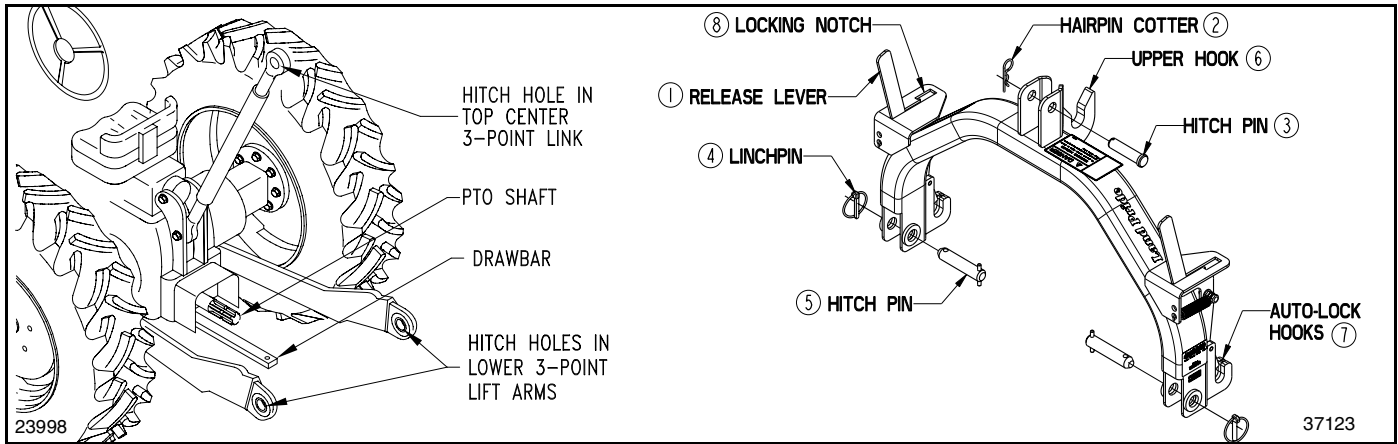

Tractor Hook-Up to QH05 Quick Hitch  
Figure 1-1

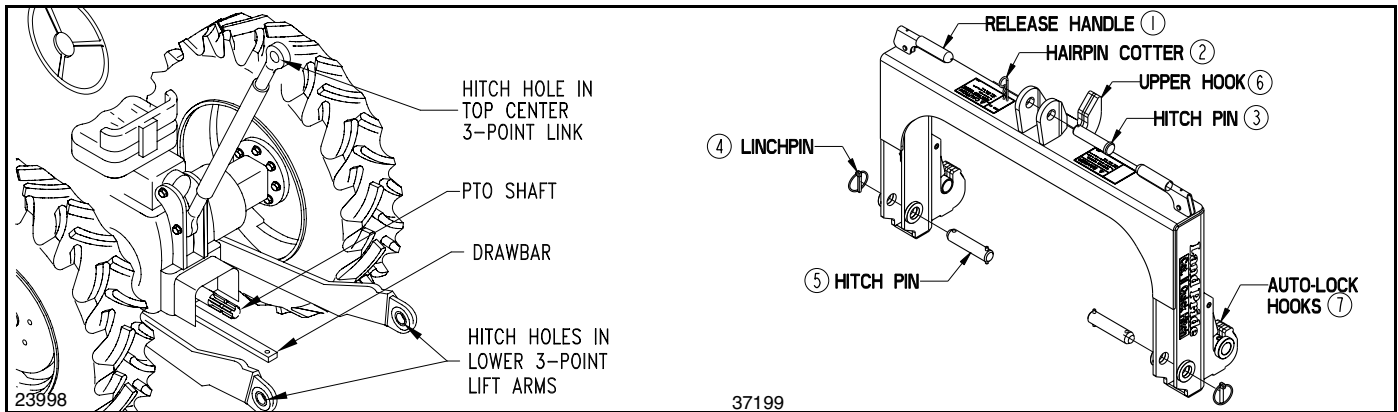

Tractor Hook-Up to QH10, QH15, QH20 & QH30 Quick Hitches  
Figure 1-2

Tractor Hook-Up

**CAUTION**

To avoid minor or moderate injury:

Keep a firm grip on the Quick Hitch at all times while hooking it to a tractor. Keep feet and all other body extremities out from under the lower 3-point hitch areas as the unit could fall causing serious injury. When possible, have a second person on hand to help.

**IMPORTANT:** Because of its weight, hooking up the QH30 by yourself is not recommended. Use an overhead hoist or the help of a second person to hook the QH30 from your tractor.

Refer to Figure 1-1 or Figure 1-2:

1. Park tractor on level ground, place gear selector in park or set park brake, shut tractor engine off, lower 3-point arms fully down, and remove switch key before dismounting tractor.
2. Make sure release levers/handles (#1) are set to auto-lock by doing the following:

Refer to Figure 1-1: Move QH05 release levers (#1) from locking notches (#8) to full forward to position as shown.

Refer to Figure 1-2: Rotate the QH10, QH15, QH20 or QH30 release handles (#1) down as shown.

3. Sit Quick Hitch upright on the ground close to the lower 3-point lift arm hitch holes with auto-lock hooks (#7) facing away from the tractor.
4. Remove hairpin cotter (#2) and hitch pin (#3). Remove linchpins (#4) and hitch pins (#5).
5. Raise right-hand side of Quick Hitch to align hitch pin holes with hitch hole in lower right lift arm. Insert hitch pin (#5) and secure with linchpin (#4).
6. Repeat step 5 to hook-up left-hand side of Quick Hitch to the tractor.
7. Attach top center 3-point link to the Quick Hitch with hitch pin (#3) and secure with hairpin cotter (#2).
8. Level Quick Hitch vertically by adjusting the length of the tractor's top center link. Refer to tractor Operator's Manual for detailed instructions.
9. Level Quick Hitch horizontally by adjusting one of the tractor's lower lift arms up or down. Refer to tractor Operator's Manual for detailed instructions.

## Section 1: Assembly & Set-Up

### Implement Hook-Up to QH05

Go to Page 13 for “Implement Hook-Up to QH10”  
go to page 14 for “Implement Hook-Up to QH15”  
go to page 16 for “Implement Hook-Up to QH20”  
and page 17 for “Implement Hook-Up to QH30”.

**NOTE:** Quick Hitch hook-up to tractor is required before proceeding with implement hook-up.

### DANGER

*To avoid serious injury or death:*

*A crushing hazard exists while hooking-up and unhooking the implement. Keep people and animals away while backing-up to the implement or pulling away from the implement. Do not operate hydraulic controls while a person or animal is directly behind the power machine or near the implement.*

### Hook-up Without Floating Top Links

Refer to Figure 1-3:

1. Make certain implement’s lower hitch pins are secured in their respective clevises.
2. Move Quick Hitch release levers from lock position to full forward position as shown. If unit is too light, you may need to start with release levers in locking notch and release levers when hooked up.
3. Lower 3-point lift arms until auto-lock hooks are below the implement’s lower hitch pins and upper hook is below upper hitch point.
4. Carefully back tractor to align auto-lock hooks under the implement’s lower hitch pins and upper hook below upper hitch point.

5. Slowly raise 3-point lift arms until auto-lock hooks lock onto the implement’s lower hitch pins and upper hook captures implement’s upper hitch point.

**IMPORTANT:** Make certain lower hitch pins are fully seated in the auto-lock hooks and release levers are fully forward. Also, make sure upper hitch point is captured in the Quick Hitch upper hook.

**IMPORTANT:** When hooking-up a driveline, make sure it is not too short to comply with shaft overlapping guidelines. Refer to your implement Operator’s Manual for driveline hook-up instructions. Replace driveline shafts and shields if they are too short. See your nearest Land Pride dealer for new shafts and shields.

6. If required, follow implement guidelines for driveline hook-up and required driveline length.

### Hook-up With Floating Top Links

1. Complete steps 1-6 above except shorten top center link to keep upper hook from capturing implement’s upper hitch point.
2. Attach floating top links to Quick Hitch and implement. Refer to “**Floating Top Link**” on page 21 for detailed instructions.

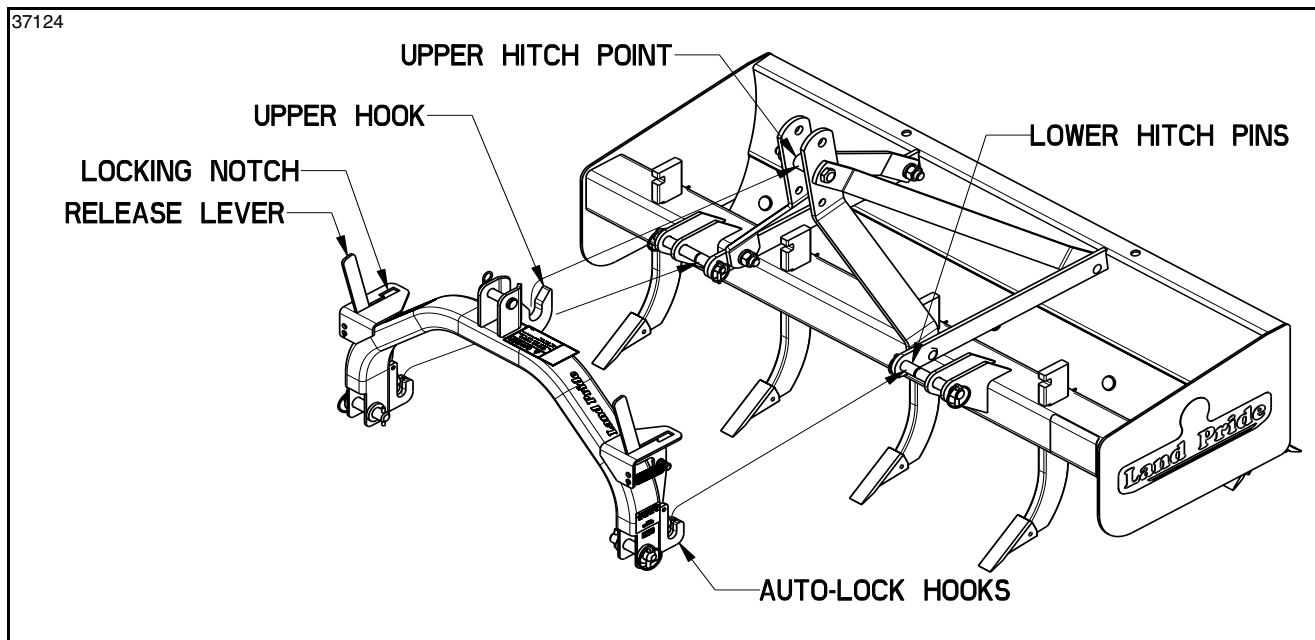

**Implement Hook-Up with QH05**

**Figure 1-3**

Section 1: Assembly & Set-Up

**Implement Hook-Up to QH10**

Go to page 12 for “Implement Hook-Up to QH05”  
 go to page 14 for “Implement Hook-Up to QH15”  
 go to page 16 for “Implement Hook-Up to QH20”  
 and page 17 for **Implement Hook-Up to QH30**.

**NOTE:** Quick Hitch hook-up to tractor is required before proceeding with implement hook-up.

**! DANGER**  
 To avoid serious injury or death:  
 A crushing hazard exists while hooking-up and unhooking the implement. Keep people and animals away while backing-up to the implement or pulling away from the implement. Do not operate hydraulic controls while a person or animal is directly behind the power machine or near the implement.

**! CAUTION**  
 To avoid minor or moderate injury:  
 Release Handles have areas where pinching can occur. Keep hands, fingers, and other body parts away from the pivoting areas of the release handles. Always use handle grips.

**Hook-up Without Floating Top Links**

Refer to Figure 1-4:

1. Make certain implement’s lower hitch pins are secured in their respective clevises.
2. Move Quick Hitch release levers from lock position to full forward position as shown. If unit is too light, you may need to start with release levers in locking notch and release levers when hooked up.

3. Place Quick Hitch release handles in the down position as shown.
4. Carefully back tractor to align auto-lock hooks under the implement’s lower hitch pins and upper hook below upper hitch point.
5. Slowly raise 3-point lift arms until auto-lock hooks lock onto the implement’s lower hitch pins and upper hook captures implement’s upper hitch point.

**IMPORTANT:** Make certain lower hitch pins are fully seated in the auto-lock hooks and captured with lock arms above. Also, make sure upper hitch point is captured in the Quick Hitch upper hook.

**IMPORTANT:** When hooking-up a driveline, make sure it is not too short to comply with shaft overlapping guidelines. Refer to your implement Operator’s Manual for driveline hook-up instructions. Replace driveline shafts and shields if they are too short. See your nearest Land Pride dealer for new shafts and shields.

6. If required, follow implement guidelines for driveline hook-up and required driveline length.

**Hook-up With Floating Top Links**

1. Complete steps 1-6 above except shorten top center link to keep upper hook from capturing implement’s upper hitch point.
2. Attach floating top links to Quick Hitch and implement. Refer to “**Floating Top Link**” on page 21 for detailed instructions.

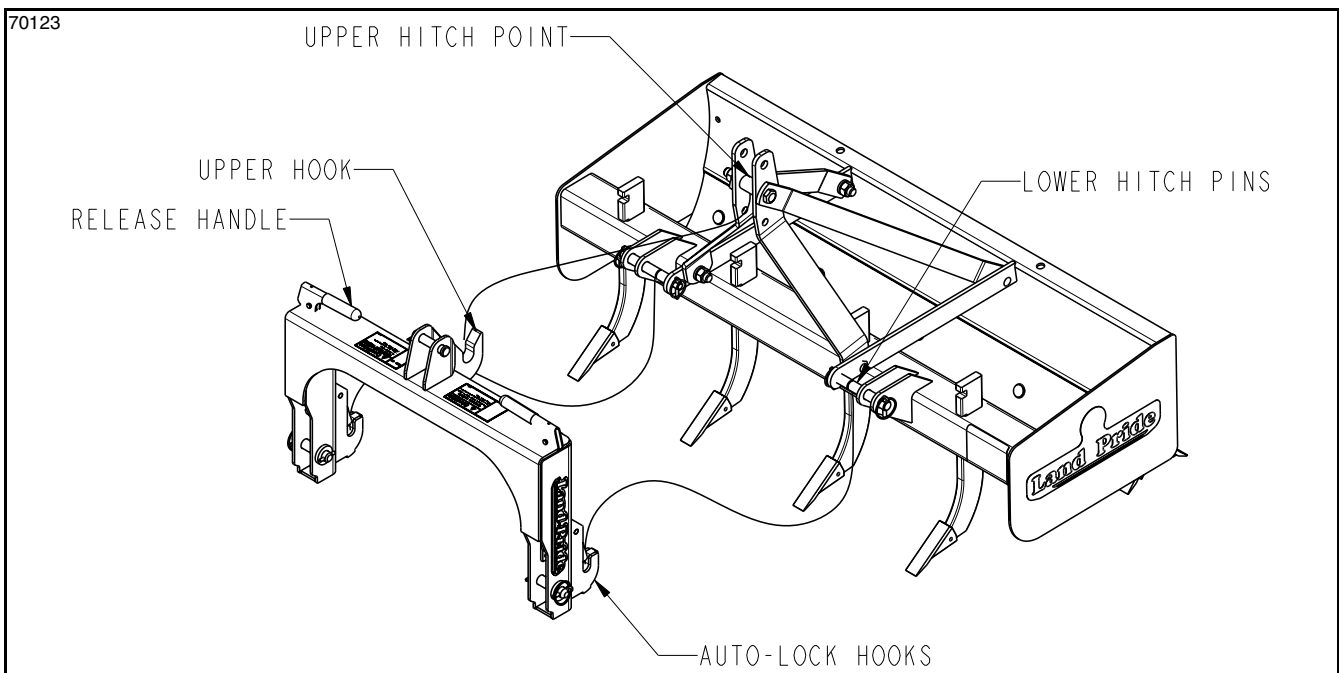

**Implement Hook-Up with QH10**  
 Figure 1-4



Section 1: Assembly & Set-Up

**Implement Hook-Up to QH15**

Go to page 12 for “Implement Hook-Up to QH05”  
 go to page 13 for “Implement Hook-Up to QH10”  
 got to page 16 for “Implement Hook-Up to QH20”  
 and page 17 for “Implement Hook-Up to QH30”.

**! DANGER**

To avoid serious injury or death:

A crushing hazard exists while hooking-up and unhooking the implement. Keep people and animals away while backing-up to the implement or pulling away from the implement. Do not operate hydraulic controls while a person or animal is directly behind the power machine or near the implement.

**! CAUTION**

To avoid minor or moderate injury:

Release Handles have areas where pinching can occur. Keep hands, fingers, and other body parts away from the pivoting areas of the release handles. Always use handle grips.

**QH15 Upper Hook Adjustment**

Refer to Figure 1-5 & Figure 1-7 on page 15:

The QH15 Quick Hitch upper hook is normally adjusted for a standard Category I configuration. Adjust upper hook if implement being attached is not a standard Cat. I configuration. (See Figure 1-7)

**NOTE:** Quick Hitch hook-up to tractor is required before proceeding with center hook adjustment.

1. Lower tractor’s 3-point lift and carefully back Quick Hitch up to align the auto-lock hooks with the implement’s lower 3-point hitch pins. Verify that the upper hook aligns with the implement’s upper hitch point. (See Figure 1-7)
2. Skip to “**Lower Cat. I Single Hitch Pin Set-up**” on this page if all three hooks align properly. Otherwise, continue with step 3 below.
3. Place gear selector in park or set park brake, shut tractor engine off, lower 3-point arms down, and remove switch key before dismounting tractor.
4. Remove hairpin cotters and clevis pins securing upper hook. Move upper hook up or down to align with implement’s upper hitch point.
5. Replace clevis pins and hairpin cotters.

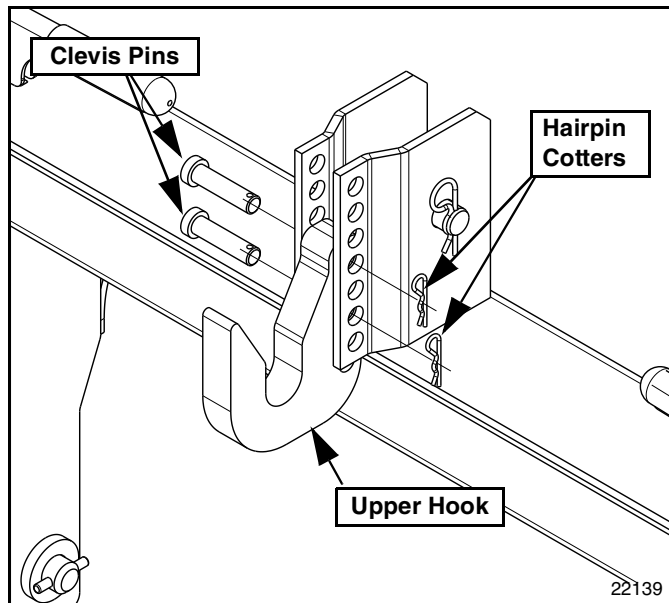

**QH15 Upper Hook Adjustment**  
 Figure 1-5

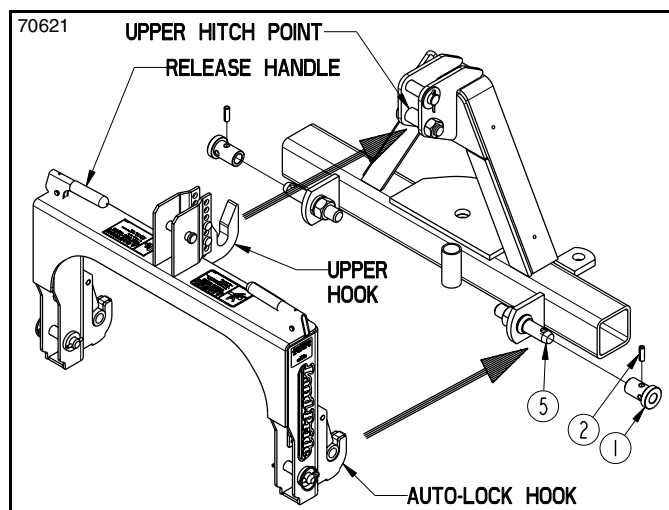

**QH15 Hook-up to Implement With Lower Cat I Hitch Pins**  
 Figure 1-6

**Lower Cat. I Single Hitch Pin Set-up**

Refer to Figure 1-6:

1. Land Pride recommends that two lower stepped Cat. I to Cat. III bushings (#1) with roll pins (#2) be purchased from your nearest nearby Land Pride dealer when hooking up to an implement supplied with Cat. I single hitch pins. Ask for bushing kit number 320-034A.
2. Install bushings (#1) onto lower hitch pins. Secure bushings by inserting roll pins (#2) in bushings (#1) and hitch pins (#5) as shown. This will provide a tighter and more secure mounting in the Quick Hitch auto-lock hooks.
3. Continue with “**Hook-up Without Floating Top Links**” on page 15.



## Section 1: Assembly & Set-Up

### Hook-up Without Floating Top Links

**Refer to Figure 1-7:**

1. Beginning with S/N 388293 and above, two 320-048D lower bushings (#3) are shipped tied to the Land Pride Quick Hitch. Install these bushings onto the implement's lower 7/8" hitch pins (#1) to provide a tighter and more secure mounting.
2. Make certain implement's lower hitch pins (#1) are secured in their respective clevis.
3. Place Quick Hitch release handles in the down position as shown.
4. Lower tractor's 3-point lift arms until auto-lock hooks are below implement's lower bushings (#3) and upper hook is below upper hitch point (#4).
5. Carefully back tractor to align auto-lock hooks under implement's lower bushings (#3) and upper hook below upper hitch point (#4).
6. Slowly raise 3-point lift arms until auto-lock hooks lock onto the implement's lower bushings and upper hook captures implement's upper hitch point.

**IMPORTANT:** Make certain lower hitch pins are fully seated in the auto-lock hooks and captured with lock arms above. Also, make sure upper hitch point is captured in the Quick Hitch upper hook.

**IMPORTANT:** When hooking-up a driveline, make sure it is not too short to comply with shaft overlapping guidelines. Refer to your implement Operator's Manual for driveline hook-up instructions. Replace driveline shafts and shields if they are too short. See your nearest Land Pride dealer for new shafts and shields.

7. If required, follow implement guidelines for driveline hook-up and required driveline length.

### Hook-up With Floating Top Links

1. Complete steps 1-7 on this page except shorten top center link to keep upper hook from capturing implement's upper hitch point.
2. Attach floating top links to Quick Hitch and implement. Refer to **"Floating Top Link"** on page 21 for detailed instructions.

### QH15 Spare Bushings

Additional bushings may be purchased from your local Land Pride dealer to make more than one implement readily available for quick hook-up. If implement has single lower hitch pins, bushing kit #320-034A is recommended. refer to **"Lower Cat. I Single Hitch Pin Set-up"** on page 14.

<b>QH15 Lower Bushings</b>	
Part No.	Part Description
320-034A	2- Stepped Bushings CAT. I to CAT. III Adapter
320-048D	Spacer Tube 1.44" O.D. x .91" I.D. x 1 9/32" lg.
320-044D	Spacer Tube 1.44" O.D. x .93" I.D. x 1 1/2" lg.
320-045D	Spacer Tube 1.44" O.D. x .93" I.D. x 1 15/16" lg.
320-050D	Spacer Tube 1.44" O.D. x .93" I.D. x 2 3/16" lg.
320-051D	Spacer Tube 1.44" O.D. x .93" I.D. x 2 7/16" lg.
325-017D	Spacer Tube 1.44" O.D. x .93" I.D. x 2 7/8" lg.
320-052D	Spacer Tube 1.44" O.D. x .93" I.D. x 3 1/2" lg.

### QH20 Spare Bushings

Additional bushings may be purchased from your local Land Pride dealer so that more than one implement is readily available for quick hook-up.

<b>QH20 Lower Bushings</b>	
Part No.	Part Description
890-938C	Stepped Bushing CAT. II to CAT. III Adapter
890-939C	Spacer Tube 1.44" O.D. x 1.14" I.D. x 1 3/4" lg.
890-940C	Spacer Tube 1.44" O.D. x 1.14" I.D. x 2 1/2" lg.
890-941C	Spacer Tube 1.44" O.D. x 1.14" I.D. x 2 3/4" lg.

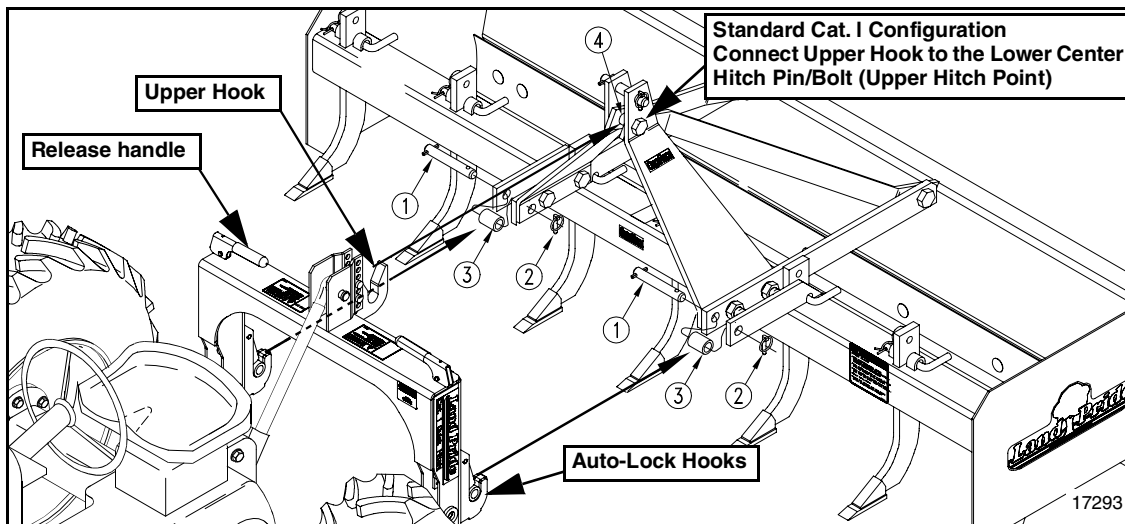

**Implement Hook-Up  
Figure 1-7**

## Section 1: Assembly & Set-Up

### Implement Hook-Up to QH20

Go to page 12 for “Implement Hook-Up to QH05”  
go to page 13 for “Implement Hook-Up to QH10”  
go to page 14 for “Implement Hook-Up to QH15”  
and page 17 for “Implement Hook-Up to QH30”.

**NOTE:** Quick Hitch hook-up to tractor is required before proceeding with implement hook-up.

#### **DANGER**

*To avoid serious injury or death:*

*A crushing hazard exists while hooking-up and unhooking the implement. Keep people and animals away while backing-up to the implement or pulling away from the implement. Do not operate hydraulic controls while a person or animal is directly behind the power machine or near the implement.*

#### **CAUTION**

*To avoid minor or moderate injury:*

*Release Handles have areas where pinching can occur. Keep hands, fingers, and other body parts away from the pivoting areas of the release handles. Always use the handle grips.*

### Lower Hitch Pin Set-up

Refer to Figure 1-8:

1. Two 890-938C lower bushings (#1) and roll pins (#2) are in a bag nailed to the crate.
2. Install bushings (#1) onto lower hitch pins. Secure bushings by inserting roll pins (#2) through bushings (#1) and hitch pins (#5) as shown. This will provide a tighter and more secure mounting in the Quick Hitch auto-lock hooks.
3. Continue with “Hook-up Without Floating Top Links” at the bottom of this page.

### Lower Clevis Pin Set-up

Refer to Figure 1-9:

1. Two 890-938C lower bushings (#1) and roll pins (#2) are in a bag nailed to the crate. Roll pins (#2) are not required in this application.
2. Install flange bushings (#1) over implement hitch pins (#6) or customer can supply 1 7/16" OD bushings (#3) in lieu of flange bushing (#1). See “QH20 Spare Bushings” on page 15.
3. Secure hitch pin (#6) with customer supplied linchpin (#4).
4. Continue with “Hook-up Without Floating Top Links” below.

### Hook-up Without Floating Top Links

Refer to Figure 1-8 & Figure 1-9:

1. Make certain implement’s upper and lower hitch pins are secured in their respective clevis.
2. Place Quick Hitch release handles in the down position as shown.

3. Lower 3-point lift arms until auto-lock hooks are below implement’s lower bushings (#1 or #3) and upper hook is below upper hitch point.
4. Carefully back tractor to align auto-lock hooks under implement’s lower bushings (#1 or #3) and upper hook below upper hitch point.
5. Slowly raise 3-point arms until auto-lock hooks lock onto the implement’s lower bushings (#1 or #3) and upper hook captures implement’s upper hitch point.

**IMPORTANT:** Make certain lower hitch pins are fully seated in the auto-lock hooks and captured with lock arms above. Also, make sure upper hitch point is captured in the Quick Hitch upper hook.

**IMPORTANT:** When hooking-up a driveline, make sure it is not too short to comply with shaft overlapping guidelines. Refer to your implement Operator’s Manual for driveline hook-up instructions. Replace driveline shafts and shields if they are too short. See your nearest Land Pride dealer for new shafts and shields.

6. If required, follow implement guidelines for driveline hook-up and required driveline length.

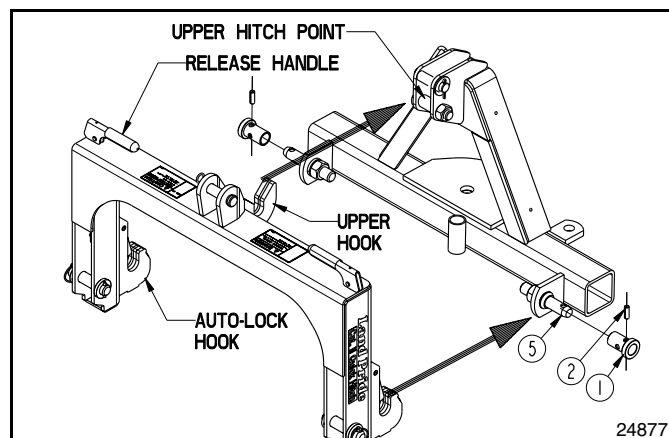

**QH20 Hook-up to Implement With Lower Hitch Pins  
Figure 1-8**

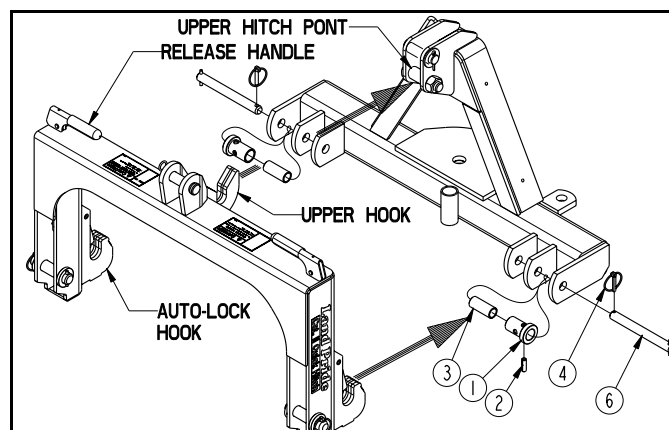

**QH20 Hook-up to Implement With Lower Clevis Pins  
Figure 1-9**



## Section 1: Assembly & Set-Up

### Hook-up With Floating Top Links

1. Complete steps 1 to 6 under “**Hook-up Without Floating Top Links**” on page 16 except shorten top center link to keep upper hook from capturing implement’s upper hitch point.
2. Attach floating top links to Quick Hitch and implement. Refer to “**Floating Top Link**” on page 21 for detailed instructions.

### Implement Hook-Up to QH30

Go to page 12 for “**Implement Hook-Up to QH05**”  
 go to page 13 for “**Implement Hook-Up to QH10**”  
 go to page 14 for “**Implement Hook-Up to QH15**”  
 and page 16 for “**Implement Hook-Up to QH20**”.

**NOTE:** Quick Hitch hook-up to tractor is required before proceeding with implement hook-up.

### DANGER

To avoid serious injury or death:

A crushing hazard exists while hooking-up and unhooking the implement. Keep people and animals away while backing-up to the implement or pulling away from the implement. Do not operate hydraulic controls while a person or animal is directly behind the power machine or near the implement.

### CAUTION

To avoid minor or moderate injury:

Release Handles have areas where pinching can occur. Keep hands, fingers, and other body parts away from the pivoting areas of the release handles. Always use the handle grips.

### Refer to Figure 1-10:

1. Make certain implement’s lower hitch pins are secured in their respective clevises.
2. Place Quick Hitch release handles in the down position as shown.
3. Carefully back tractor to align auto-lock hooks under the implement’s lower hitch pins and upper hook below upper hitch point.
4. Slowly raise 3-point lift arms until auto-lock hooks lock onto the implement’s lower hitch pins and upper hook captures implement’s upper hitch point.

**IMPORTANT:** Make certain lower hitch pins are fully seated in the auto-lock hooks and captured with lock arms above. Also, make sure upper hitch point is captured in the Quick Hitch upper hook.

**IMPORTANT:** When hooking-up a driveline, make sure it is not too short to comply with shaft overlapping guidelines. Refer to your implement Operator’s Manual for driveline hook-up instructions. Replace driveline shafts and shields if they are too short. See your nearest Land Pride dealer for new shafts and shields.

5. If required, follow implement guidelines for driveline hook-up and required driveline length.

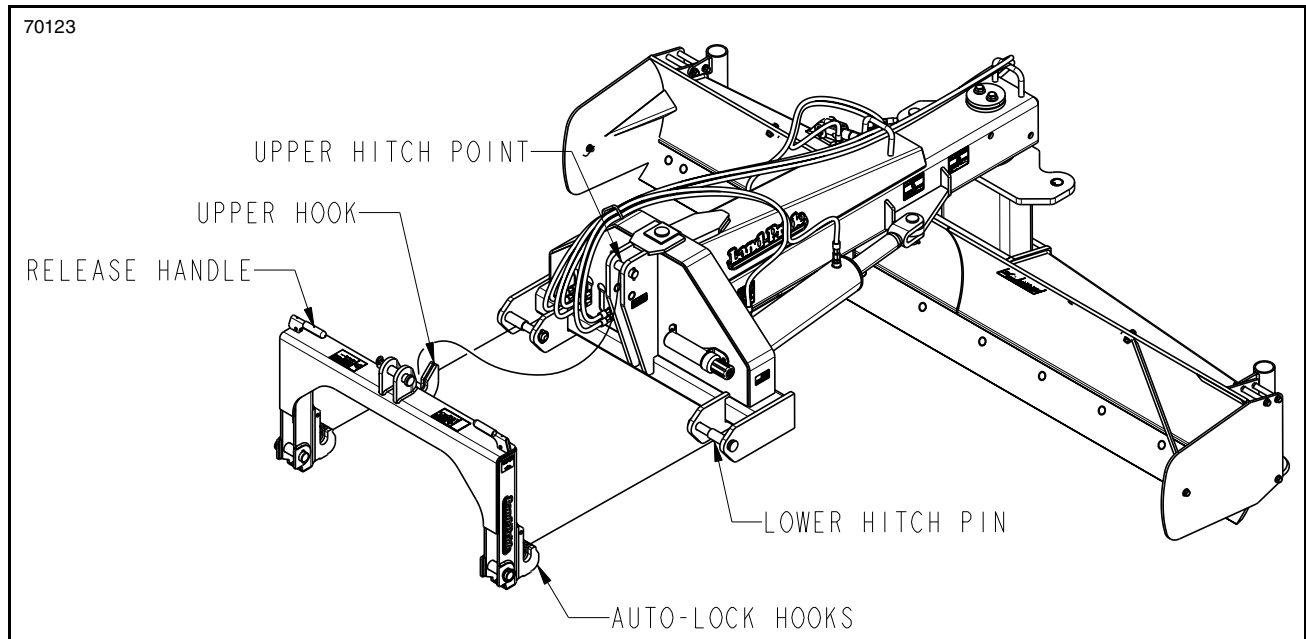

**Implement Hook-Up with QH30**  
**Figure 1-10**

## Section 1: Assembly & Set-Up

### Unhooking Implement

#### DANGER

To avoid serious injury or death:

A crushing hazard exists while hooking-up and unhooking the implement. Keep people and animals away while backing-up to the implement or pulling away from the implement. Do not operate hydraulic controls while a person or animal is directly behind the power machine or near the implement.

1. If engaged, disengage power take-off, park tractor on level ground, and place gear selector in park or set park brake.
2. If implement has a parking stand, raise implement off the ground slightly higher than what is needed to set parking stand to support implement.
3. Shut tractor engine off and remove switch key before dismounting tractor.
4. If applicable, set parking stand to support implement.
5. Without starting tractor, lower implement to ground.
6. If applicable, unhook driveline safety chain from tractor and pull driveline yoke from tractor power take-off shaft.
7. Disconnect floating top link as follows:
  - If floating top link is used only with this implement, remove hairpin cotter and hitch pin connecting floating top link to the Quick Hitch.
  - If floating top link will be used on other implements, remove hairpin cotter, hitch pin, and bushing connecting floating top link to the implement. Bushing not included with QH20 floating top link.
8. Reinstall hardware in floating top link for storage.
9. Move Quick Hitch release levers/handles as follows:
  - **QH05:** Move release levers to locking notches as shown in Figure 1-11. Make sure levers are retained by the locking notches.
  - **QH10, QH15, QH20 & QH30:** Pull release handles up to the position shown in Figure 1-12.
10. Restart tractor and lower 3-point lift arms until auto-lock hooks are below implement hitch pins and upper hook is below implement upper hitch point.
11. Slowly drive tractor forward several feet while watching to make sure Quick Hitch does not catch on implement while pulling away.
12. Place gear selector in park or set park brake, lower 3-point arms down, shut tractor engine off, and remove switch key before dismounting tractor.
13. Store driveline off the ground. See implement Operator's Manual for instructions on how to store driveline.

14. If floating top link will not be used with another Quick Hitch hook-up, remove hairpin cotter and hitch pin connecting floating top link to the Quick Hitch.
15. Reinstall removed hardware in floating top link. Store floating top link in a location where it can be easily located later.

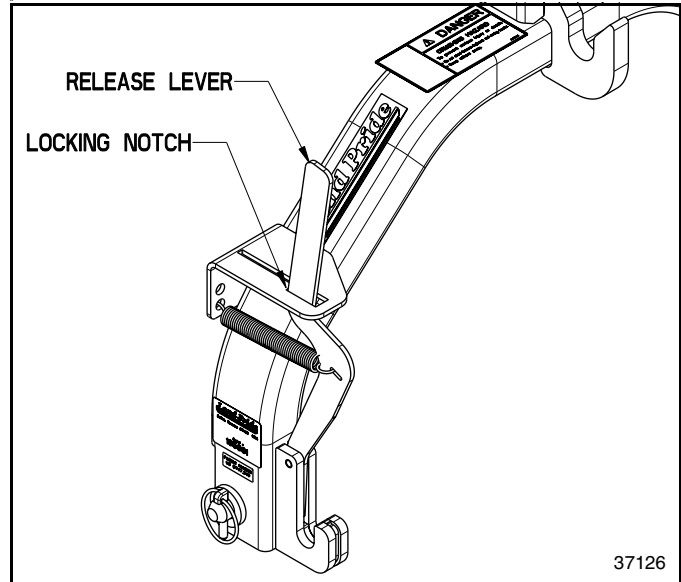

**QH05 Shown With Handles Secured In Locking Notches**  
Figure 1-11

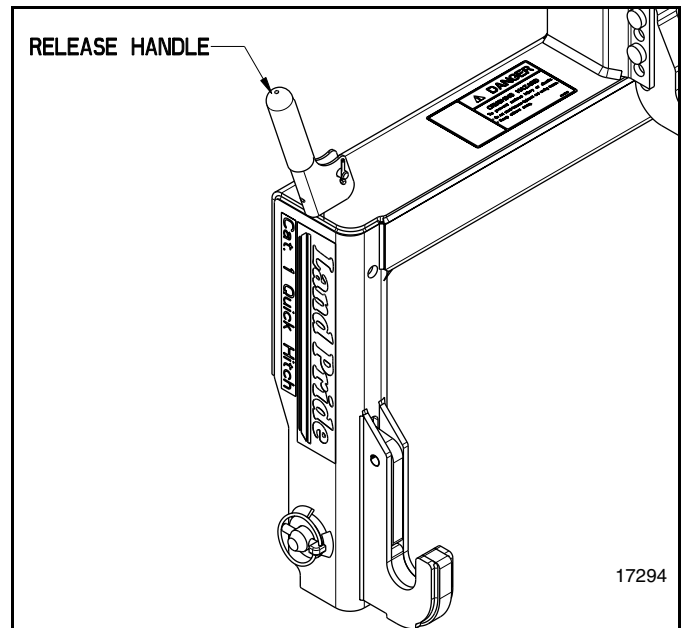

**QH10, QH15, QH20 QH30 Shown With Handles Pointing Up**  
Figure 1-12

## Section 1: Assembly & Set-Up

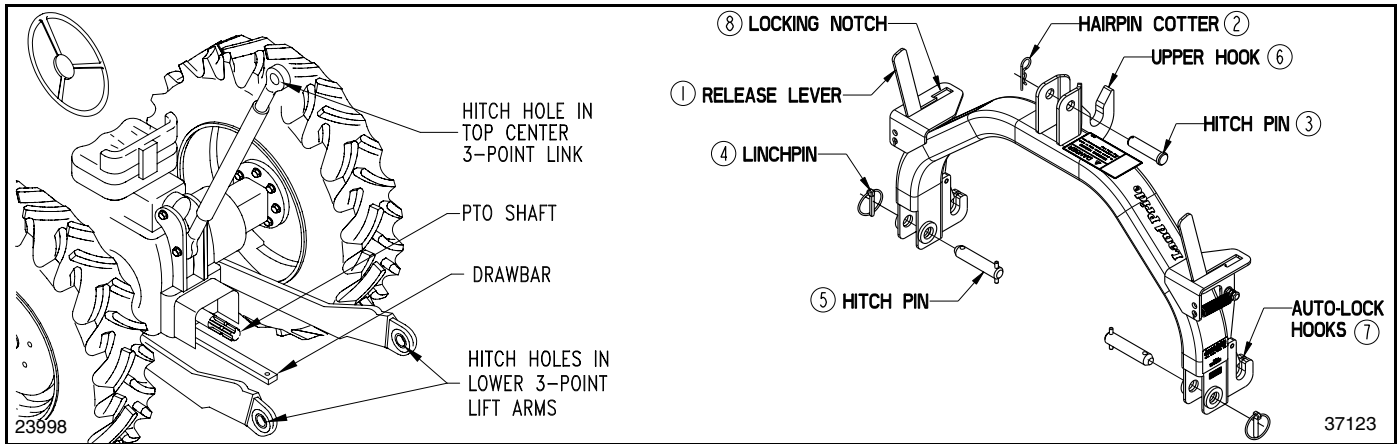

**Unhooking QH05 Quick Hitch**  
Figure 1-13

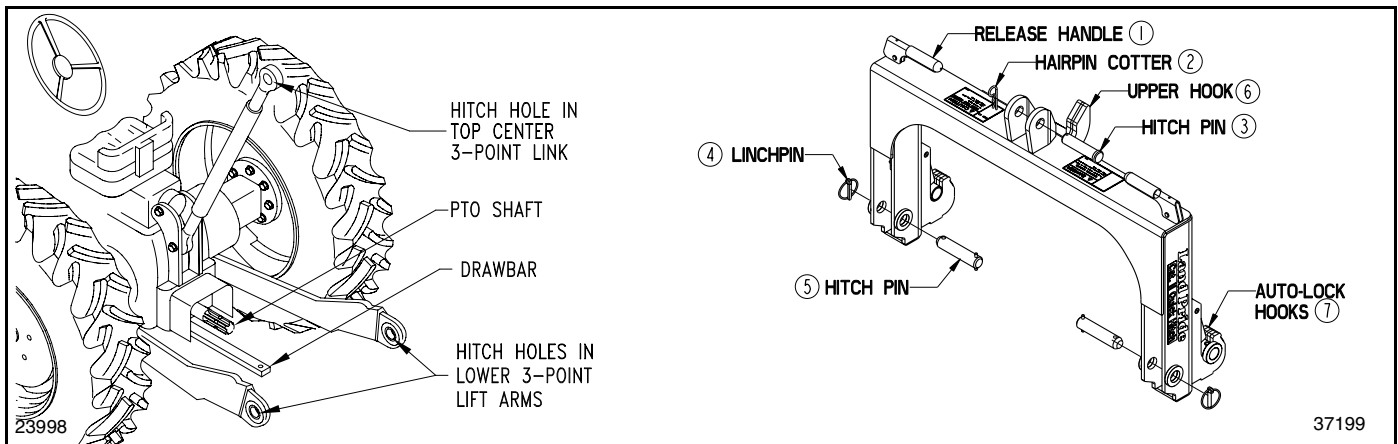

**Unhooking QH10, QH15, QH20 & QH30 Quick Hitches**  
Figure 1-14

### Unhooking Quick Hitch

#### CAUTION

To avoid minor or moderate injury:

Keep a firm grip on the Quick Hitch at all times while unhooking it from a tractor. Keep feet and all other body extremities out from under the lower 3-point hitch areas as the unit could fall causing serious injury. When possible, have a second person on hand to help.

Refer to Figure 1-13 & Figure 1-14:

1. Park tractor on level ground, place gear selector in park or set park brake, shut tractor engine off, lower 3-point lift arms fully down, and remove switch key before dismounting tractor.
2. Set release levers/handles (#1) to make Quick Hitch ready for hook-up to an implement as follows:

**Refer to Figure 1-13:** Move QH05 release levers (#1) from locking notches to forward position as shown.

**Refer to Figure 1-14:** Rotate QH10, QH15, QH20 or QH30 release handles (#1) down to position shown.

**IMPORTANT:** Because of its weight, unhooking the QH30 by yourself is not recommended. Use an overhead hoist or the help of a second person to unhook the QH30 from your tractor.

3. Keep Quick Hitch from rotating on lower 3-point hitch pins (#5) while removing upper center hairpin cotter (#2) and hitch pin (#3). Secure center 3-point link in its retainer at the back of the tractor.
4. Continue supporting Quick Hitch while removing lower 3-point linchpin (#4) and hitch pin (#5) on the right-hand side. Lower right-hand side of Quick Hitch to ground.
5. Continue to support Quick Hitch while removing remaining linchpin (#4) and hitch pin (#5) on the left-hand side. Lower left-hand side of Quick Hitch to the ground.
6. Replace removed hitch pins (#3 & #5), linchpins (#4), and hairpin cotter (#2) in the Quick Hitch for safe keeping.
7. Store Quick Hitch in an area where it can easily be seen and not hidden by grass and weeds growing over it.



## Section 2: Operating Instructions

### Operating Checklist

Hazard control and accident prevention are dependent upon the awareness, concern, prudence and proper training involved in the operation, transport, maintenance and storage of the Quick Hitch. Therefore, it is absolutely essential that no one operates this hitch unless they have read, fully understood, and are totally familiar with the Operator's Manual. Make sure the operator has paid particular attention to:

- **Important Safety Information**, page 1
- **Section 1: Assembly & Set-Up**, page 10
- **Section 2: Operating Instructions**, page 20
- **Section 3: Optional Equipment**, page 21
- **Section 4: Maintenance & Lubrication**, page 24

### Transporting

#### **DANGER**

*To avoid serious injury or death:*

- *Always use accessory lights and other available warning devices to alert other vehicle operators of your presence when traveling on public roads night and day.*
  - *Release levers should always be fully forward when using QH05 Quick Hitch. Release handles should always be in the down position when using QH10, QH15, QH20 or QH30 Quick Hitch.*
1. Transport only with a tractor of sufficient size and horsepower for handling the attached implement.
  2. If included, make sure driveline does not contact tractor, Quick Hitch, or implement when raising implement to transport position.
  3. Select a safe ground speed to transport. Never transport with an attached implement above 20 mph.
  4. Reduce tractor ground speed when turning and leave enough turning clearance to make sure implement does not contact obstacles such as buildings, trees or fences.
  5. Shift tractor to a lower gear when traveling over rough or hilly terrain.
  6. When traveling on roadways, transport in such a way that faster moving vehicles may pass you safely.

#### **CAUTION**

*To avoid minor or moderate injury:*

*Comply with all federal, state, and local laws when traveling on public roads.*

### Operating Instructions

Once you have familiarized yourself with the Operator's Manual, completed the Operator's Checklist, and properly attached your Land Pride Quick Hitch to your tractor's 3-point hitch mounting, you should be just about ready to start "management and handling" of your compatible Category I or Category II 3-point implements.

You will notice we emphasize "**Management and Handling**" when we refer to your implements. If you are going to gain the benefit of owning a Land Pride Quick Hitch you will need to park your implements on a firm surface ensuring that the hitch pins and driveline remain upright and oriented for future Quick Hitch alignment and attachment. Allowing the lower hitch pins and upper hitch point to tumble forward into the dirt or mud will not be acceptable or compatible with this fast hook-up system. This simply is a better way to manage your time, your implements, and your investment.

Now you are ready to use your Quick Hitch. Pull your QH05 locking levers out of their locking notches and forward or rotate your QH10/QH15/QH20/QH30 locking handles down. This will set the quick release locks into the auto-lock position. Start your tractor and slowly back up centering on the implement you want to attach. Lower your three-point so the Quick Hitch auto-lock hooks and upper hook line up under the implements lower and upper hitch points simultaneously. Slowly raise the Quick Hitch until all three hitch points are captured and the lower hitch points automatically lock in place. If you do not have a driveline to hook-up, you should be ready for transport. If you do have a driveline, lower the implement to the ground, place gear selector in park or set tractor park brake, turn off engine, remove switch key, dismount tractor, and install driveline.

When you are ready to detach implement, position implement over a firm surface or prepared docking point that will keep the lower and upper hitch points properly oriented for future attachment. With the implement still off the ground, place gear selector in park or set the park brake, turn off tractor, remove switch key, and dismount tractor. Disconnect driveline safety chain and driveline if one is being used. Move QH05 locking levers to the locking notches or pull up on the QH10/QH15/QH20/QH30 locking handles to remove the automatic locks. Return to the tractor, start engine and slowly lower the 3-point hitch until the implement is on the ground and the Quick Hitch releases the implement. Pull forward until you are safely clear. With a little practice you should get very good at hooking and unhooking quickly.

Section 3: Optional Equipment

Floating Top Link

Implements with gauge wheel(s) usually require a floating top link to allow the gauge wheel(s) to float with the contour of the land. Land Pride offers optional Floating Top Link Kits designed to adapt the QH05, QH10, QH15 and QH20 Quick Hitches for those products:

Determine which Quick Hitch you have and refer to the following installation instructions for that hitch.

- For the QH05 Quick Hitch, refer to “QH05 Floating Top Link Installation” instructions on this page.
- For the QH10 Quick Hitch, refer to “QH10 Floating Top Link Installation” instructions on page 22.
- For the QH15 Quick Hitch, refer to “QH15 Floating Top Link Installation” instructions on page 22.
- For the QH20 Quick Hitch, refer to “QH20 Floating Top Link Installation” instructions on page 23.

QH05 Floating Top Link Installation

Refer to Figure 3-1:

1. Remove existing 3/4" x 2 3/4" clevis pin (#7) and hairpin cotter (#5). Store hairpin cotter for safe keeping.
2. Attach floating link bars (#3) to the Quick Hitch as shown with six flat washers (#4) and 3/4" x 4" clevis pin (#6A). Secure clevis pin with hairpin cotter (#5).
3. Assemble spacer (#2) in implement's top link (#1) and place implement's top link between links (#3) as shown. Secure top link with clevis pin (#6B) and secure pin with hairpin cotter (#5).

QH05 Floating Top link Components

320-052A QH05 Floating Top Link Assembly Kit

Below is a detailed listing of parts included in this kit to serve as a checklist to inventory parts received.

Qty	Part No.	Part Description
2	805-228C	PIN CLEVIS 3/4 X 3 3/4 PLT
2	320-137D	QH05 FLOATING TOP LINK BAR
6	804-024C	WASHER FLAT 3/4 USS PLT
2	805-143C	PIN HAIR COTTER .120 PLT
1	320-035D	FLT TOP SPCER 1.12 OD x .81 ID x1 15/16

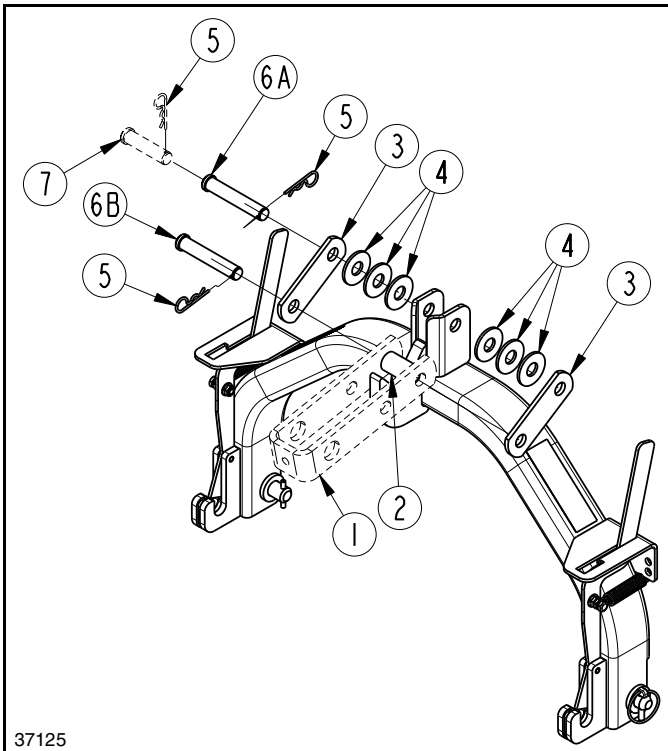

37125

QH05 Floating Top Link Installation  
Figure 3-1





Section 3: Optional Equipment

**QH10 Floating Top Link Installation**

Refer to Figure 3-2:

1. Remove existing 3/4" x 3 3/4" clevis pin (#7) and hairpin cotter (#5). Store hairpin cotter for safe keeping.
2. Attach floating link bars (#3) to the Quick Hitch as shown with six flat washers (#4) and 3/4" x 4" clevis pin (#6A). Secure clevis pin with hairpin cotter (#5).
3. Assemble spacer (#2) in implement's top link (#1) and place implement's top link between links (#3) as shown. Secure top link with clevis pin (#6B) and secure pin with hairpin cotter (#5).

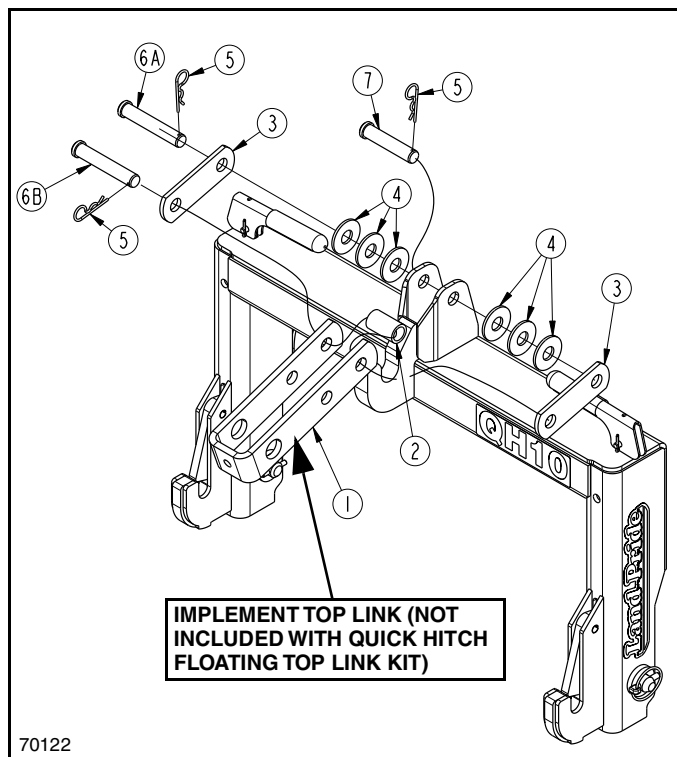

QH10 Floating Top Link Installation  
Figure 3-2

**QH10 Floating Top link Components**

320-052A QH10 Floating Top Link Assembly Kit

Below is a detailed listing of parts included in this kit to serve as a checklist to inventory parts received.

Qty	Part No.	Part Description
2	805-228C	PIN CLEVIS 3/4 X 3 3/4 PLT
2	320-137D	QH05 FLOATING TOP LINK BAR
6	804-024C	WASHER FLAT 3/4 USS PLT
2	805-143C	PIN HAIR COTTER .120 PLT
1	320-035D	FLT TOP SPCER 1.12 OD x .81 ID x1 15/16

**QH15 Floating Top Link Installation**

Refer to Figure 3-3:

**NOTE:** If Floating Top Link Kit is assembled on units with Serial Numbers 269719 and below, then the bolts, nuts, and lock washers used to secure the top adjustable hook (indicated with large arrow in Figure 3-3) should be replaced with two clevis pins 805-303C and two hairpin cotters 805-010C. This is due to the existing bolts being too long.

1. Remove existing 3/4" x 3 1/2" clevis pin (#5) and hairpin cotter (#6). Keep clevis pin and hairpin cotter for reuse when hooking-up without floating top link.
2. Attach floating link bars (#2) to the Quick Hitch as shown with four flat washers (#4) on nut side of clevis (nut side noted with larger arrow) and 3/4" x 3 3/4" clevis pin (#7A). Secure pin with hairpin cotter (#6).
3. Assemble spacer (#3) in implement's top link and place implement's top link between links (#2) as shown. Secure with clevis pin (#7B) and hairpin cotter (#6).

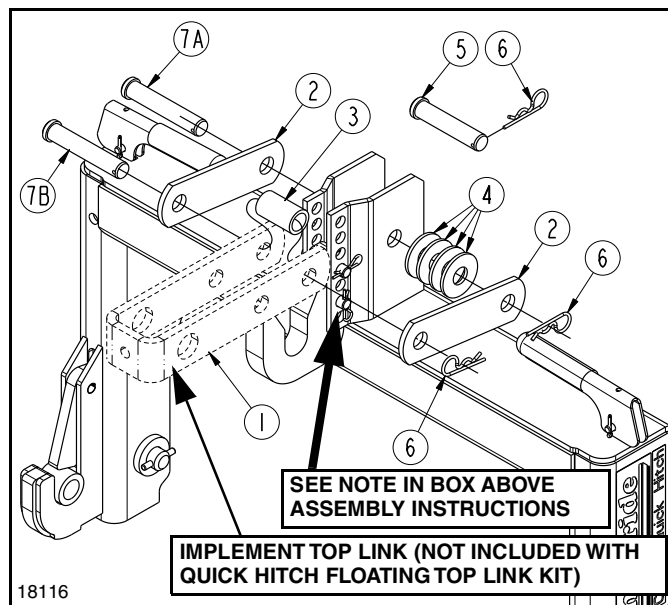

QH15 Floating Top Link Installation  
Figure 3-3

**QH15 Floating Top link Components**

320-013A QH15 Floating Top Link Assembly Kit

Below is a detailed listing of parts included in this kit to serve as a checklist to inventory parts received.

Qty	Part No.	Part Description
2	805-228C	PIN CLEVIS 3/4 X 3 3/4 PLT
2	320-034D	QH FLOATING TOP LINK BAR
4	804-024C	WASHER FLAT 3/4 USS PLT
2	805-143C	PIN HAIR COTTER .120 PLT
1	320-035D	FLT TOP SPCER 1.12 OD x .81 ID x1 15/16

Section 3: Optional Equipment

**QH20 Floating Top Link Installation**

Refer to Figure 3-4:

1. Remove existing 1" x 3 1/2" clevis pin (#4) and hairpin cotter (#6). Keep clevis pin and hairpin cotter for reuse when hooking-up without floating top link.
2. Attach floating link bars (#2) to the Quick Hitch as shown with flat washers (#3) and 1" x 4 1/2" clevis pin (#5A). Secure clevis pin with hairpin cotter (#6).
3. Attach implement's top link (#1) between floating link bars (#2) as shown with clevis pin (#5B). Secure clevis pin with hairpin cotter (#6).

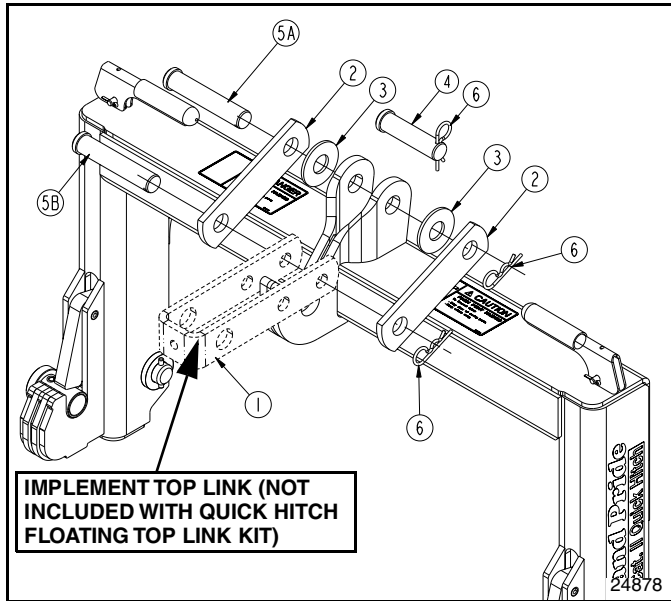

QH20 Floating Top Link Installation  
Figure 3-4

**QH20 Floating Top link Components**

320-028A QH20 Floating Top Link Assembly Kit

Below is a detailed listing of parts included in this kit to serve as a checklist to inventory parts received.

Qty	Part No.	Part Description
2	320-067D	QH FLOATING TOP LINK CAT II
2	804-028C	WASHER FLAT 1 USS PLT
2	805-131C	PIN CLEVIS 1 X 4 11/16 USABLE
2	805-032C	PIN HAIR COTTER .148 PLT

**Floating Top Link Positioning**

**Operating Position**

Refer to Figure 3-5:

1. Park tractor and implement on level ground.
2. Adjust rear gauge wheel(s) to the correct working height.
3. Lower implement with tractor's 3-point lift until the front is at the correct working height. Rear gauge wheel(s) should be on the ground supporting the implement's rear end. If not, lengthen tractor's 3-point top center link until the rear end is supported by the gauge wheel(s).

**NOTE:** Refer to implement's operating manual for a complete description on how to set the implement to the correct working height.

4. With implement set at the correct working height, adjust 3-point top center link until the floating top two links dip halfway down into the upper hook as shown.

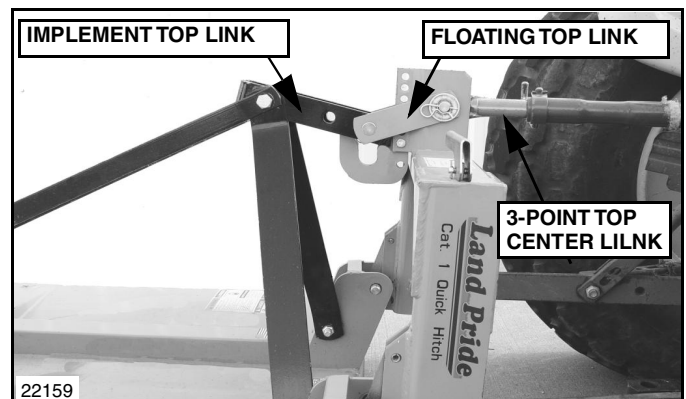

Floating Top Link Position When  
Tail Wheel & Skid Shoes Are On The Ground  
Figure 3-5

**Transporting Position**

Refer to Figure 3-6:

The floating top links should be straight as shown when implement's gauge wheel(s) are raised off the ground.

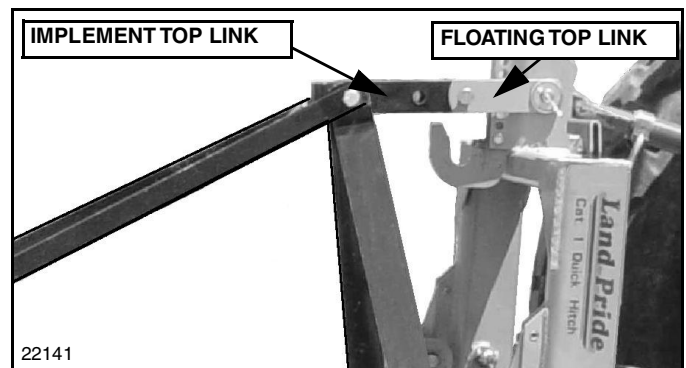

Floating Top Link Position When  
Tail Wheel & Skid Shoes Are Off The Ground  
Figure 3-6



Section 4: Maintenance & Lubrication

**Maintenance**

Proper servicing and adjustments are key to the long life of any implement. With careful inspection and routine maintenance, you can avoid costly downtime and repair.

After using your QH05, QH10, QH15, QH20 or QH30 Quick Hitch for several hours, check all bolts to be sure they are tight. Replace any worn, damaged, or illegible safety labels by obtaining new labels from your Land Pride dealer.

**! WARNING**

To avoid serious injury or death:

- Do not alter implement or replace parts on the implement with other brands. Other brands may not fit properly or meet OEM (Original Equipment Manufacturer) specifications. They can weaken the integrity and impair the safety, function, performance, and life of the implement. Replace parts only with genuine OEM parts.
- Make sure controls are all in neutral position or park before starting the power machine.

**Long-Term Storage**

Clean, inspect, service, and make necessary repairs to the implement when storing it for long periods and at the end of the season. This will help to ensure the unit is ready for field use the next time you hook-up to it.

1. Remove any dirt and grease that may have accumulated on the hitch and moving parts. Scrape off compacted dirt and then wash surface thoroughly with a garden hose. A coating of oil may also be applied to unpainted area to minimize oxidation.
2. Check for loose, damaged or worn parts and adjust or replace as needed.
3. Repaint parts where paint is worn or scratched to prevent rust. Ask your Land Pride dealer for aerosol touch-up paint. Paint is also available in touch-up bottles with brush, quarts, and gallon sizes by adding TU, QT, or GL to the end of the aerosol part number.

Land Pride Touch-up Paint	
Part No.	Part Description
821-066C	PAINT ORANGE SPRAY CAN
821-070C	PAINT GP GLOSS BLACK SPRAY CAN

4. Replace all damaged or missing decals.
5. Lubricate as noted under “**Lubrication Points**” below.
6. Store Quick Hitch on a level surface in a clean, dry place. Inside storage will reduce maintenance and make for a longer hitch life.

**Lubrication Points**

**Lubrication Legend**

- Multi-purpose spray lube
- Multi-purpose grease lube
- Multi-purpose oil lube
- 50 Hrs Intervals in hours at which lubrication is required

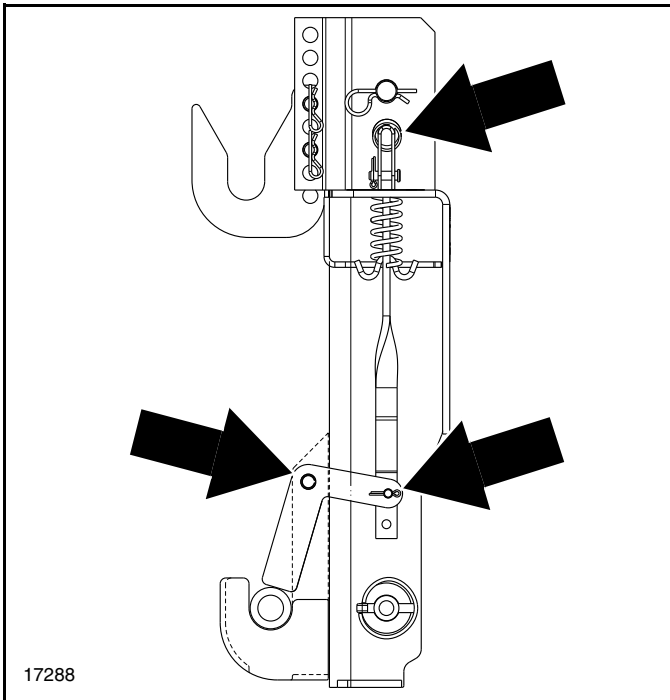

**As Required**

**Pivot points (QH10, QH15, QH20 & QH30)**

Multi-purpose Spray Lube  
Quantity = Generously





QH05, QH10, QH15, QH20, & QH30 Series

Specifications & Capacities					
Model	QH05	QH10	QH15	QH20	QH30
3-Point hitch	Category 1	Category 1	Category 1	Category 2	Category 3
Maximum lift Capacity	At 24" (61.0 cm) back from implement's lower 3-point hitch pins. Implement hitch must match hitch category listed above.				
	700 lbs (317.5 kg)	2000 lbs (907.2 kg)	2000 lbs (907.2 kg)	3600 lbs (1632.9 kg)	13600 lbs (6168.9 kg)
Overall width	32 1/4" (81.9 cm)	32 5/8" (82.9 cm)	32 5/8" (82.9 cm)	40" (1.02 m)	46 1/4" (1.17 m)
Overall height	20 1/4" (51.4 cm)	21 3/4" (55.2 cm)	23 1/4" (59.1 cm)	23 5/8" (60.0 cm)	28 5/8" (72.7 cm)
Overall length	7 3/8" (18.7 cm)	8" (20.3 cm)	9" (22.9 cm)	8 7/8" (22.5 cm)	9 1/2" (24.1 cm)
Weight without floating top link	37 lbs (16.8 kg)	67 lbs (30.4 kg)	70 lbs (31.8 kg)	120 lbs (54.4 kg)	175 lbs (79.4 kg)
Top hitch	Stationary	Stationary	Adjustable	Stationary	Stationary
Hitch pin lock	Automatic on implement's lower 3-point hitch pins				

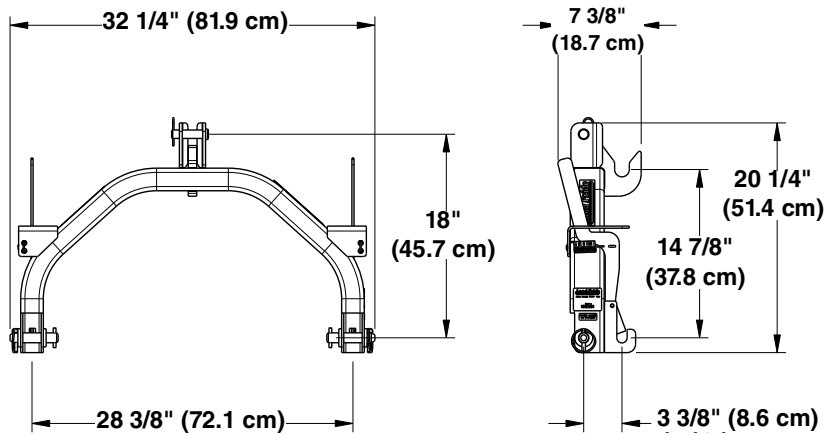

QH05 Quick Hitch  
Figure 5-1

37128

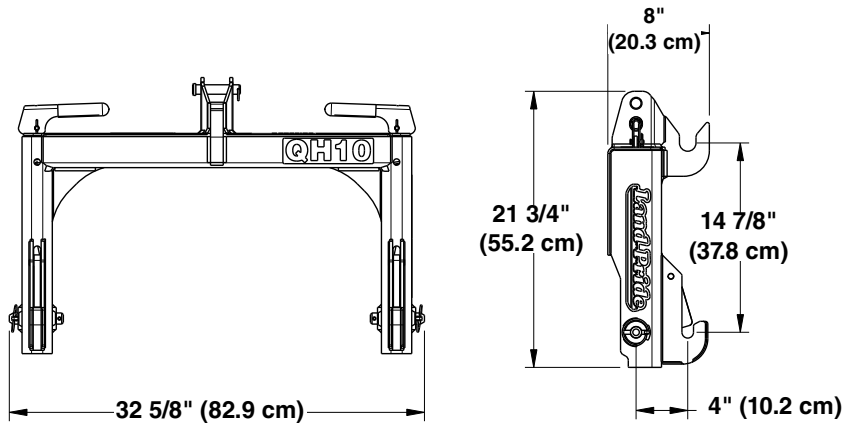

QH10 Quick Hitch  
Figure 5-2

70121

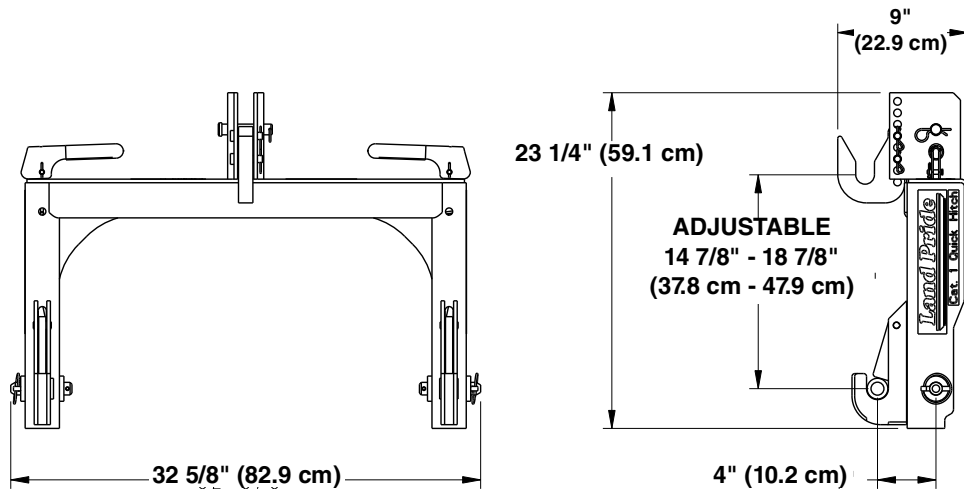

QH15 Quick Hitch  
Figure 5-3

26874

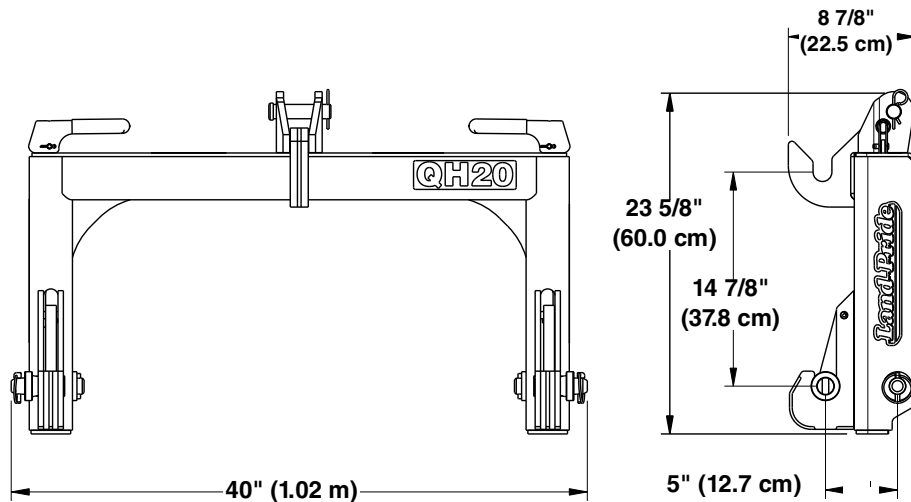

QH20 Quick Hitch  
Figure 5-4

24879

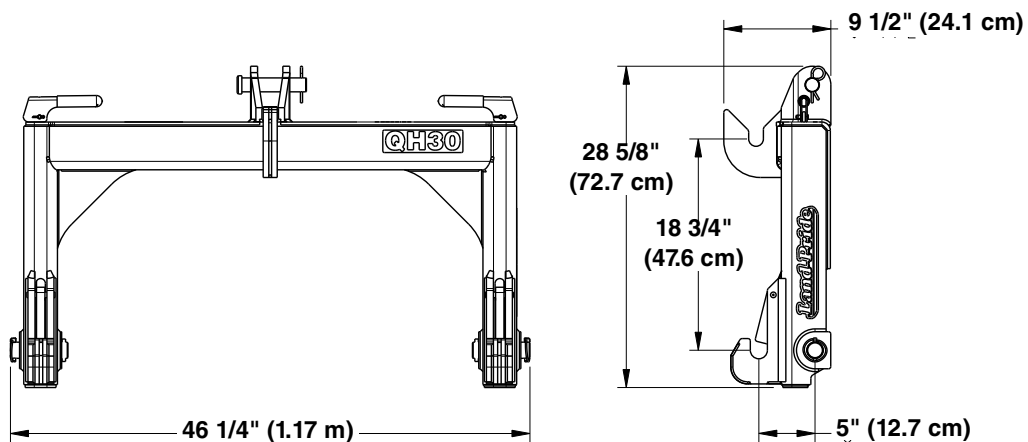

QH30 Quick Hitch  
Figure 5-5

70315



Section 6: Features & Benefits

QH05, QH10, QH15, QH20, & QH30 Series

Features & Benefits					
Model Number	QH05	QH10	QH15	QH20	QH30
Adjustable top hook (QH15 Only)	N/A	N/A	Enables adjustment if needed on implements that are not true Cat. I	N/A	N/A
Standard lower link pin size	7/8" Cat. I pin size	7/8" Cat. I pin size	7/8" Cat. I pin size	1 1/8" Cat II pin size	1 7/16 Cat III pin size
Accepts various lower hitch pin sizes	N/A	N/A	Various pins up to 1 1/8" can be securely locked	Various pins up to 1 7/16" can be securely locked	N/A
Design fits variety of Land Pride products.	Useful time saver when working on multiple projects.				
Optional floating top link	For implements that have a swiveling top link.				N/A
Automatic lock on lower 3-point pins	Lower pins on implement lock into place, no need to get off tractor.				
Cost effective versatility	Only one unit needed per tractor and implement. No separate piece for the implement side.				



Section 7: Torque Values Chart

Torque Values Chart for Common Bolt Sizes													
Bolt Size (inches)	Bolt Head Identification						Bolt Size (Metric)	Bolt Head Identification					
	Grade 2		Grade 5		Grade 8			Class 5.8		Class 8.8		Class 10.9	
in-tpi <sup>1</sup>	N · m <sup>2</sup>	ft-lb <sup>3</sup>	N · m	ft-lb	N · m	ft-lb	mm x pitch <sup>4</sup>	N · m	ft-lb	N · m	ft-lb	N · m	ft-lb
1/4" - 20	7.4	5.6	11	8	16	12	M 5 X 0.8	4	3	6	5	9	7
1/4" - 28	8.5	6	13	10	18	14	M 6 X 1	7	5	11	8	15	11
5/16" - 18	15	11	24	17	33	25	M 8 X 1.25	17	12	26	19	36	27
5/16" - 24	17	13	26	19	37	27	M 8 X 1	18	13	28	21	39	29
3/8" - 16	27	20	42	31	59	44	M10 X 1.5	33	24	52	39	72	53
3/8" - 24	31	22	47	35	67	49	M10 X 0.75	39	29	61	45	85	62
7/16" - 14	43	32	67	49	95	70	M12 X 1.75	58	42	91	67	125	93
7/16" - 20	49	36	75	55	105	78	M12 X 1.5	60	44	95	70	130	97
1/2" - 13	66	49	105	76	145	105	M12 X 1	90	66	105	77	145	105
1/2" - 20	75	55	115	85	165	120	M14 X 2	92	68	145	105	200	150
9/16" - 12	95	70	150	110	210	155	M14 X 1.5	99	73	155	115	215	160
9/16" - 18	105	79	165	120	235	170	M16 X 2	145	105	225	165	315	230
5/8" - 11	130	97	205	150	285	210	M16 X 1.5	155	115	240	180	335	245
5/8" - 18	150	110	230	170	325	240	M18 X 2.5	195	145	310	230	405	300
3/4" - 10	235	170	360	265	510	375	M18 X 1.5	220	165	350	260	485	355
3/4" - 16	260	190	405	295	570	420	M20 X 2.5	280	205	440	325	610	450
7/8" - 9	225	165	585	430	820	605	M20 X 1.5	310	230	650	480	900	665
7/8" - 14	250	185	640	475	905	670	M24 X 3	480	355	760	560	1050	780
1" - 8	340	250	875	645	1230	910	M24 X 2	525	390	830	610	1150	845
1" - 12	370	275	955	705	1350	995	M30 X 3.5	960	705	1510	1120	2100	1550
1-1/8" - 7	480	355	1080	795	1750	1290	M30 X 2	1060	785	1680	1240	2320	1710
1-1/8" - 12	540	395	1210	890	1960	1440	M36 X 3.5	1730	1270	2650	1950	3660	2700
1-1/4" - 7	680	500	1520	1120	2460	1820	M36 X 2	1880	1380	2960	2190	4100	3220
1-1/4" - 12	750	555	1680	1240	2730	2010	<sup>1</sup> in-tpi = nominal thread diameter in inches-threads per inch <sup>2</sup> N · m = newton-meters <sup>3</sup> ft-lb= foot pounds <sup>4</sup> mm x pitch = nominal thread diameter in millimeters x thread pitch						
1-3/8" - 6	890	655	1990	1470	3230	2380							
1-3/8" - 12	1010	745	2270	1670	3680	2710							
1-1/2" - 6	1180	870	2640	1950	4290	3160							
1-1/2" - 12	1330	980	2970	2190	4820	3560							

Torque tolerance + 0%, -15% of torquing values. Unless otherwise specified use torque values listed above.  
 All locknuts or lubricated fasteners: Use 75% of torque value. (i.e. 1/2"-13 GR5 = 76 ft-lb; 75% of 76 or .75 x 76 = 57 ft-lb)

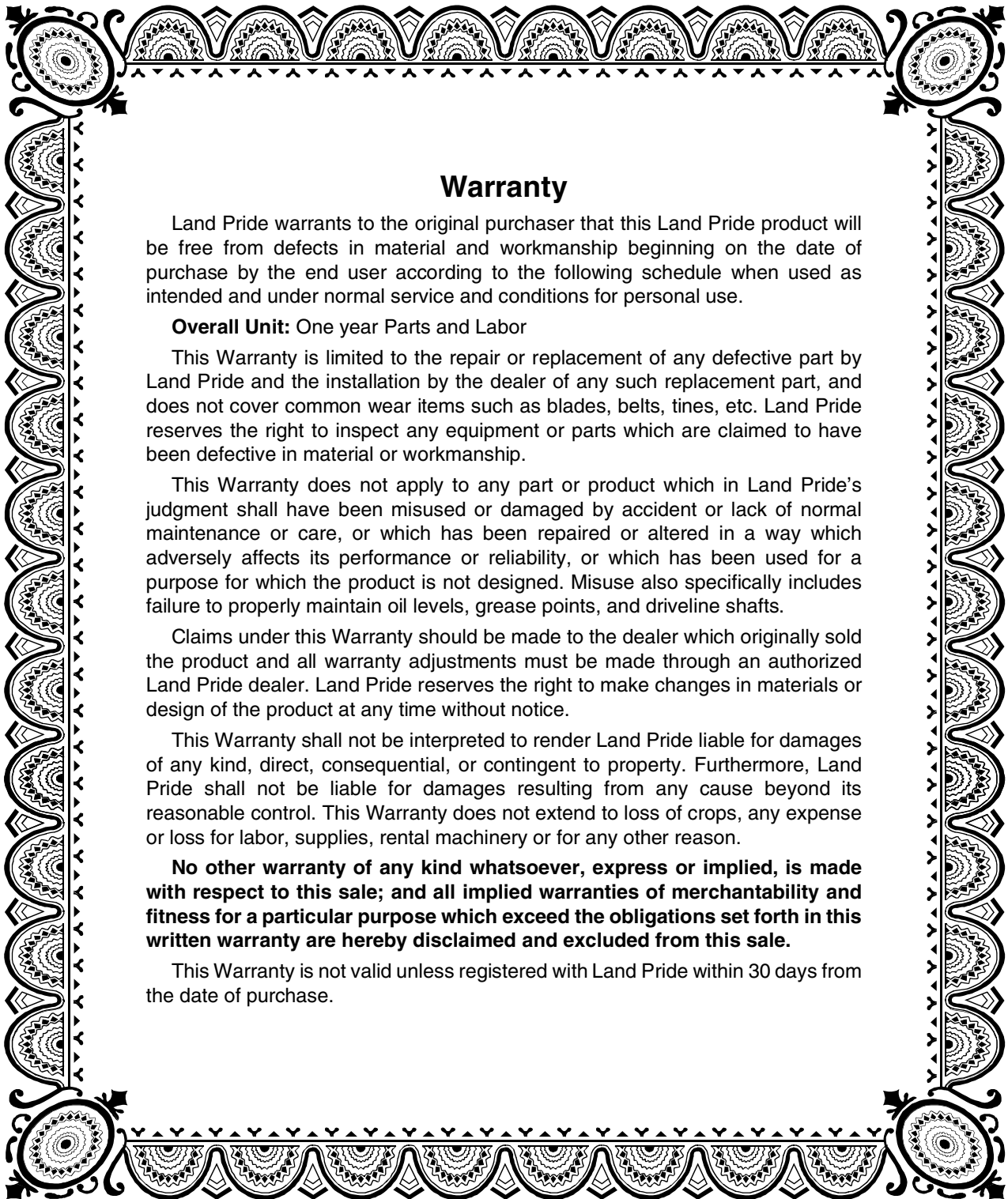

## Warranty

Land Pride warrants to the original purchaser that this Land Pride product will be free from defects in material and workmanship beginning on the date of purchase by the end user according to the following schedule when used as intended and under normal service and conditions for personal use.

**Overall Unit: One year Parts and Labor**

This Warranty is limited to the repair or replacement of any defective part by Land Pride and the installation by the dealer of any such replacement part, and does not cover common wear items such as blades, belts, tines, etc. Land Pride reserves the right to inspect any equipment or parts which are claimed to have been defective in material or workmanship.

This Warranty does not apply to any part or product which in Land Pride's judgment shall have been misused or damaged by accident or lack of normal maintenance or care, or which has been repaired or altered in a way which adversely affects its performance or reliability, or which has been used for a purpose for which the product is not designed. Misuse also specifically includes failure to properly maintain oil levels, grease points, and driveline shafts.

Claims under this Warranty should be made to the dealer which originally sold the product and all warranty adjustments must be made through an authorized Land Pride dealer. Land Pride reserves the right to make changes in materials or design of the product at any time without notice.

This Warranty shall not be interpreted to render Land Pride liable for damages of any kind, direct, consequential, or contingent to property. Furthermore, Land Pride shall not be liable for damages resulting from any cause beyond its reasonable control. This Warranty does not extend to loss of crops, any expense or loss for labor, supplies, rental machinery or for any other reason.

**No other warranty of any kind whatsoever, express or implied, is made with respect to this sale; and all implied warranties of merchantability and fitness for a particular purpose which exceed the obligations set forth in this written warranty are hereby disclaimed and excluded from this sale.**

This Warranty is not valid unless registered with Land Pride within 30 days from the date of purchase.

**IMPORTANT:** The Online Warranty Registration should be completed by the dealer at the time of purchase. This information is necessary to provide you with quality customer service.

Model Number \_\_\_\_\_

Serial Number \_\_\_\_\_



Corporate Office: P.O. Box 5060  
Salina, Kansas 67402-5060 USA  
[www.landpride.com](http://www.landpride.com)

---